

C:\Business\Three Trees Vineyard 3 trees special land use siteplan.dwg Oct 03, 2022 - 10:38am

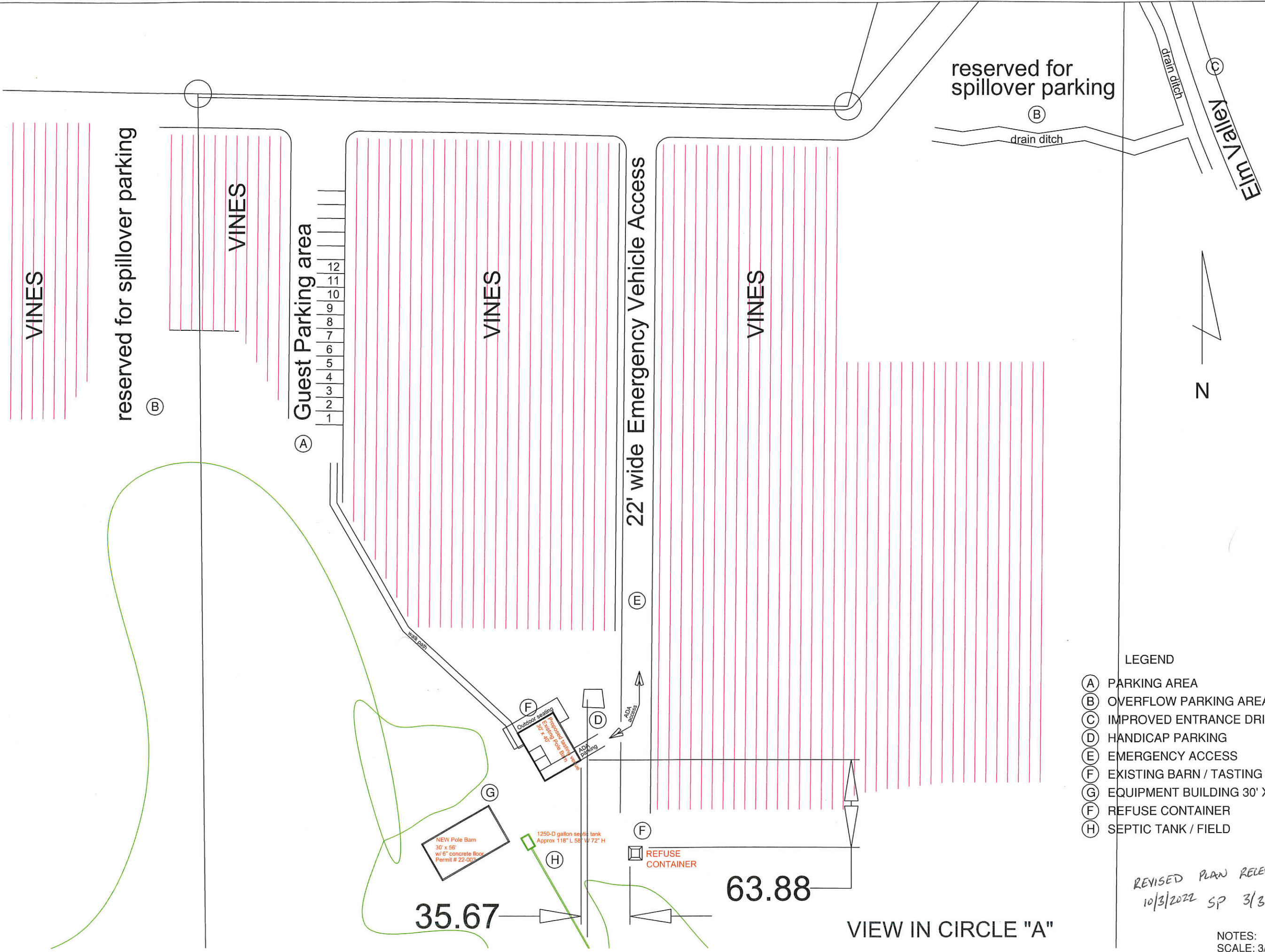

reserved for spillover parking

reserved for spillover parking

Guest Parking area

22' wide Emergency Vehicle Access

N

Elm Valley

LEGEND

- (A) PARKING AREA
- (B) OVERFLOW PARKING AREA
- (C) IMPROVED ENTRANCE DRIVE
- (D) HANDICAP PARKING
- (E) EMERGENCY ACCESS
- (F) EXISTING BARN / TASTING ROOM
- (G) EQUIPMENT BUILDING 30' X 56'
- (F) REFUSE CONTAINER
- (H) SEPTIC TANK / FIELD

D	• UPDATED W/DIMS at road	• 9-30-22
C	• UPDATED W/DIMS	• 9-4-22
B	• apron/parking added	• 2-4-22
A	• "north" symbol added	• 2-3-22
rel.	• released	• 1-22-22
Rev:	Issued For:	Date:

LAND OWNER:
FORDYCE HOLDINGS LLC
VINEYARD

OPERATED BY:
THREE TREES VINEYARD

5200 S. ELM VALLEY
SUTTONS BAY, MI., 49682

Designed:	S.M.
Drawn:	S.M.
Checked:	P.C.
Approved:	O.I. Date: 1-17-2022

Sheet Title:

VIEW IN CIRCLE "A"

Job Number: 220101
Sheet Number: 2 of

REVISED PLAN RELEASED
10/3/2022 SP 3/3

NOTES:
SCALE: 3/16"=1'

63.88

VIEW IN CIRCLE "A"

35.67

NEW Pole Barn
30' x 56'
w/ 6" concrete floor
Permit # 22-003

1250-D gallon septic tank
Approx 118" L 58" W 72" H

Outdoor seating
Proposed parking apron
50' x 40' w/ 6" concrete floor
Permit # 22-003

REFUSE CONTAINER

ADA access

walk path

drain ditch

drain ditch