

Treasurer's Report reflects  
bank account balances

**Treasurer's Report**

**FEBRUARY 2022**

	General Fund	Huntington Bank			
#101 General Fund	Huntington Bank	\$1,302,440.10			***
#203 Metro Authority	Huntington Bank	\$52,369.44			
#206 Fire Fund	Huntington Bank	\$1,227,198.56			
#207 Police	Huntington Bank	\$490.93			
#590 Sewer CD Mat May 2018	Sewer Huntington	\$421,745.21			
#591 Timberlee H20	Huntington Bank	\$411,323.45			
#592 Greilickville H20	Huntington Bank	\$132,885.45			
#594 Marina	Marina Huntington	\$1,105,863.26			
#701 Trust & Agency	Huntington Bank	\$2,250.49			
#703 Current Tax	Huntington Bank	\$92,634.17			
#815 E. Timberwoods	Huntington Bank	\$35,437.62			
#816 GSAD Receivable	Savings Huntington	\$6,548.74			
#817 SBlue & Old Orch	Huntington Bank	\$4,380.28			
#818 Old Orchard	Huntington Bank	\$7,297.05			
#820 Maintenance E.R. Rds	Huntington Bank	\$5,887.66			
#821 Maintenance S.B. Rds	Huntington Bank	\$7,335.05			
#861 Bayview Estates Lights	Huntington Bank	\$2,526.64			
<b>TOTAL</b>		<b>\$4,818,614.10</b>			

INVESTMENT ACCOUNTS CD'S	PURCHASED AMOUNT	PRIOR MONTH VALUE	CURRENT VALUE	EST MONTHLY INT	PAID INTEREST
#101 Goldman Sachs	\$200,000.00	\$202,365.67	\$200,523.38	-\$1,476.62	\$5.16
#101 SYNCHRONY BK	\$202,000.00		\$202,370.83	\$5.16	
#101 FIDELITY GOV MMKT DAILY					
#590 Ally Bank	\$250,000.00		\$251,962.50	\$1,962.50	
#590 Morgan Stanley	\$150,000.00		\$151,732.50	\$1,732.50	
#590 Flagstar Bank	\$250,000.00		\$248,260.00	-\$1,740.00	
#590 BMW BK	\$131,000.00		\$130,042.39	-\$957.61	
<b>BOND INTEREST</b>			\$5,474.38	\$5,789.59	\$315.21
#594 Dreyfus MMKT	\$150,000.00		\$150,000.00		
#594 UBS Bank	\$250,000.00		\$248,225.00	-\$1,775.00	
<b>BOND INTEREST</b>			\$157,494.18	\$157,551.27	\$57.09
<b>TOTAL</b>	<b>\$1,583,000.00</b>		<b>\$1,596,457.46</b>	<b>-\$1,876.77</b>	<b>\$377.46</b>
<b>GRAND TOTAL</b>			<b>\$6,415,071.56</b>		

Cornie M. Preston, Clerk

*Chris Mikowski*  
Chris Mikowski, Treasurer

To: Elmwood Township Board

From: Sarah Clarren, Planner/Zoning Administrator

RE: February 2022 Planning and Zoning Report

<b>PERMITS:</b>	<u>2/2022</u>	<u>2/2021</u>	<u>YTD 2022</u>	<u>YTD 2021</u>
Single Family Dwelling	2	0	2	2
Attached SFD	0	0	0	0
Accessory Building	0	2	1	3
AG Building	0	0	0	0
Residential Addition	1	0	1	1
Deck	1	0	2	0
Sign	0	0	0	0
Commercial	0	0	0	0
Misc.	0	0	0	0
Total Permit	4	2	6	6
Fees Collected	\$281.64	\$60.00	\$341.64	\$344.52

**Zoning Board of Appeals:**

**Past Meeting** – November 2021, mentioned in previous Report

**Future Meeting** – March 2, 2022 – Extension Request – ZBA 2021-01 Request by TCWC Holding Company LLC at 9440 S Center Hwy, Parcel #45-004-008-010-40 for a 10-foot height variance to construct a 45-foot-high portion of the building for equipment used in distillation in the Agricultural-Rural Zoning District.

**Planning Commission:**

**Past Meeting**

- February 15<sup>th</sup>
  - SPR 2022-01, Kaiser Building, Motel, 13356 S West-Bay Shore Drive
  - Workshop Discussion – Date and Agenda Items
  - Extension Request – SUP/SPR 2021-06 TC Whiskey Distillery Tasting Room 9440 S. Center Hwy. #45-004-008-009-00 & #45-004-008-010-40 (approved on 6/24/21 (minutes approved 7/7/21))

**Future Meeting**

- March 8<sup>th</sup>
  - SPR 2022-01, Kaiser Building, Motel, 13356 S West-Bay Shore Drive
  - Discussion on Upcoming Meeting (changing date)
  - Discussion on Workshop

**Office Updates:**

- Continues with Parks & Rec on 5-year update to the Parks & Rec Plan – next meeting 3/9/2022
- ZA continues to work on MSU Zoning Administrator Certificate program – will test by 3/25/22
- STRs. As of 3/2, please note the following:
  - A total of 75 licenses have been issued to complete applications;
  - 3 applications are currently in progress (applicants working on missing items);
  - (1) application has been withdrawn;
  - (1) application did not meet the definition of an STR.

**CHARTER TOWNSHIP OF ELMWOOD**  
**Park and Recreation Committee**  
**Regular Meeting Minutes for January 12, 2022**

- A. **Call to order:** Deborah Allen called the meeting to order @ 6:08 P.M. in the TWP Hall.
- B. **Roll Call:** Committee members present were Deborah Allen from the Board, Ed Basile, Noel Flohe, and Fernando Meza (quorum met). Also present was TWP Planner, Sarah Clarren. Not present was Kyle Trevas.
- C. **Public Comment:** None.
- D. **Agenda Modifications/Approval:** No modifications; Moved by Noel, seconded by Ed to approve as presented—U.
- E. **Minutes for December 8, 2021:** Moved by Ed, seconded by Noel to approve as printed—U.
- F. **New Business:** a. **Discussion on Parks and Recreation Plan Update:**  
The current *Community Park, Recreation, Open Space, & Greenways Plan* for Charter Township of Elmwood was approved February 11, 2018 as a Five Year plan thru 2022. Thus, this committee is charged to update our plan for the next five years beginning in 2023.
- The timeline is our biggest challenge. The committee's strategy is to first look and update what has been done since the plan's last approval in 2018. A community survey, with discussions and a Public Hearing will follow as we work thru March, April & May. Plan ideas are being targeted to be finalized so that recommendations to the Board can be accomplished by September, reaching for final adoption processing of the new plan's so it can be filed with the State of Michigan ahead of 2023 deadlines.
- For its February 9, 2022, the committee will review the first 40 pages of the 2018 plan.
- G. **Old Business:** A review of the Regular Meeting Schedule on the second Wednesday of each month at 6:00 P.M. for 2022 took place. Ed Basile noted he would be out of town March 9<sup>th</sup> & April 13<sup>th</sup>. It was agreed that he would call in so quorum can be met, etc.
- H. **Adjourn:** At 6:55 P.M. Ed moved, second by Noel to adjourn—U.

Submitted by Noel Flohe, Parks & Rec. Committee acting Secretary.

**CHARTER TOWNSHIP OF ELMWOOD  
Park and Recreation Committee  
Regular Meeting Minutes for February 9, 2022**

- A. Call to Order:** Chairman Kyle Trevas called the meeting to order @ 6:01 PM in the TWP Hall.
- B. Roll Call:** Committee members present were Kyle Trevas, Deborah Allen from the Board, Ed Basile, and Noel Flohe (quorum met). Also present were TWP Planner, Sarah Clarren and Supervisor, Jeff Shaw. Not present was Fernando Meza.
- C. Public Comment:** None.
- D. Agenda Modifications/Approval:** Moved by Deborah, second by Ed to approve the agenda as presented—U.
- E. Minutes for January 12, 2022:** Moved by Noel, second by Deborah to approve as printed—U.
- F. New Business: Selection of Officers.**  
Kyle Trevas was nominated for Chairman by Deborah, second by Ed—U.  
Noel Flohe was nominated for Secretary by Deborah, second by Ed—U  
Deborah was nominated for VP by Ed, seconded by Kyle—U.  
Noel moved the nominations be closed, second by Deborah—U.
- G. Old Business: 1. Discussion on Parks and Recreation Plan;**
- i. Review of Plan Sections:** To begin our path forward, the 2018 Plan Sections Headings would remain the same, etc.  
*Section 1—Community Overview;*  
*Section 2—Administrative Structure;*  
*Section 3—Recreation Facilities and Resource Inventories;*  
*Section 4—Description of Public Input Process;*  
*Section 5—Goals and Objectives;*  
*Section 6—Action Program*
  - 1. Review of Recreational Improvements:** As the committee works its way through each section, it notes the improvements made since filing the 2018 plan. Since our January meeting, Supervisor Jeff Shaw and Planner, Sarah Clarren reviewed this table and charted what has been accomplished, the amounts and source of funding. It's refreshing to see several big ticket items already completed with more scheduled in 2022,2023,2024. Some items are being dropped, many continue with some progress, and some new added for future work in years 2025, 2026,2027.



- ii. **Establish Schedule for Update:** More of this will be identified as the committee's work continues.
- iii. **Discussion on Outreach:** Fourteen sources of people we would like to reach out regarding the 2023 plan development were listed—this list is not exclusive.
- iv. **Discussion on Survey:** Sarah researched and noted 3 pages of questions and public response items that would help us form a survey—this list is not exhaustive.
- v. **Goals for Next Meeting:** Continue the process of discussions and questions moving forward.

**H. Comments from Committee Members and/or Staff:**

Jeff and Sarah were thanked for their very helpful prep work to the committee. The DISCOVERY CENTER & PIER flyer outlining their project's background, description, outreach, funding; \$3 million plan for October 2022 ground breaking for summer readiness in 2023 is great info. The idea that when the survey is completed, it could include a flyer note with summer tax notices for directing the public on how to access info for its completion (TWP website, etc.).

**I. Public Comments: None.**

**J. Adjourn: 8:06 PM.**

**Submitted by Noel Flohe, Parks & Rec. Committee acting secretary.**

**CHARTER TOWNSHIP OF ELMWOOD  
REGULAR BOARD MEETING  
FEBRUARY 14, 2022  
IN THE TOWNSHIP HALL**

**Call to Order:**

Supervisor Shaw called the meeting to order at 6:00 p.m.

**Pledge of Allegiance:**

Supervisor Shaw led the Pledge of Allegiance.

**Roll Call:**

**Present:** Jeff Shaw, Connie Preston, Jim O'Rourke, Chris Mikowski, Deborah Allen, and Terry Lautner

**Excused:** Dave Darga

**Declaration of Conflict of Interest:**

None

**Public Comment**

Sue Jones  
Matt McDonough

**Consent Calendar:**

**Department Reports:**

Treasurer  
Planning/Zoning  
Marina  
Fire Report

**Committee Reports:**

**Minutes:**

1-10-2021

**Post Audit Invoices 1-15-21 through 2-4-21**

MOTION BY TRUSTEE ALLEN, SECONDED BY CLERK PRESTON TO APPROVE THE CONSENT CALENDAR AS PRESENTED. The motion passed unanimously by a voice vote.

**Agenda Approval**

Supervisor Shaw requested the addition of item 10e, Parks & Recreation Committee Appointments

MOTION BY CLERK PRESTON, SECONDED BY TRUSTEE O'ROURKE TO APPROVE THE AGENDA AS AMENDED BY ADDING 10E, PARKS AND RECREATION COMMITTEE APPOINTMENTS. The motion passed unanimously by a voice vote.

**Supervisor Remarks**

Supervisor Shaw submitted a written report.

**Trustee Remarks**

Trustee Allen thanked Sarah Clarren and Jeff Shaw for attending the Parks & Recreation Committee meeting last week.

## **Engineer's Report**

None

## **Other Officer Remarks**

Chief Tampa updated the Board on department stats and employee statuses.  
Harbormaster Peter Moon updated the Board on upcoming maintenance at the marina and contract renewals

## **Communications from the Clerk**

None

## **OLD BUSINESS**

None

## **NEW BUSINESS**

### **New Furnace/Old Fire Station**

MOTION BY TRUSTEE LAUTNER, SECONDED BY TRUSTEE ALLEN TO ACCEPT THE TEAM BOBS BID IN THE AMOUNT OF \$3411.77 PLUS \$312.00 FOR REMOVAL OF THE OLD FURNACE. The motion passed by a roll call vote with Ayes from Mikowski, Lautner, Allen, Preston, and Shaw and one Nay from O'Rourke.

### **PC REQUEST FOR CLARIFICATION ON STR MOTION**

Planner Sarah Clarren reported that 73 of 93 available STR licenses have been issued. She explained that the Planning Commission would like further clarification as to what the Board meant by Greilickville neighborhoods. The consensus of the Board was to hold off any further direction until there is a new map of the STR locations.

### **Consideration of Housing North Request**

Some members of the Board were concerned with how the success of the program would be measured and how they could help within Elmwood Township. Clerk Preston stated she would contact Yarrow Brown for more information.

### **Liability Insurance/Recommended Additional Coverage**

Clerk Preston explained that Township Attorney Bryan Graham recommended increasing our coverage for cases involving non-monetary damages. He felt that for the cost of 2.5 hours of his time, we could have \$100,000.00 in coverage for defending those types of cases. MOTION BY CLERK PRESTON, SECONDED BY TRUSTEE O'ROURKE TO INCREASE COVERAGE TO \$100,000.00. The motion passed unanimously by a voice vote.

### **Parks and Recreation Committee Appointments**

MOTION BY TRUSTEE ALLEN, SECONDED BY TRUSTEE O'ROURKE TO APPROVE THE FOLLOWING REAPPOINTMENTS AS PRESENTED:

ED BASILE, 2 YEAR TERM 6/1/22 - 5/31/24  
NOEL FLOHE, 2 YEAR TERM 4/1/22 - 3/31/24  
FERNANDO MEZA, 2 YEAR TERM 6/8/22 - 6/7/24  
KYLE TREVAS, 2 YEAR TERM 5/1/22 - 4/30/24  
The motion passed unanimously by a voice vote.

**PAYMENT OF INVOICES**

MOTION BY TREASURER MIKOWSKI, SECONDED BY TRUSTEE ALLEN TO PAY THE INVOICES IN THE AMOUNT OF \$109,391.72. The motion passed unanimously by a voice vote.

**PUBLIC COMMENT**

None

**Adjournment**

Supervisor Shaw adjourned the meeting at 6:47 p.m.

DRAFT

# Check Register Report

Date: 03/07/2022

Time: 1:18 pm

Page: 1

ELMWOOD TOWNSHIP

BANK:

Check Number	Check Date	Status	Void/Stop Date	Reconcile Date	Vendor Number	Vendor Name	Check Description	Amount
<b>Checks</b>								
36263	02/28/2022	Printed			A127	AT&T MOBILITY	ACCT#287303700094	152.92
36264	02/28/2022	Printed			B111	BLUECROSS BLUESHIELD OF GROUP MI	007015150	458.22
36265	02/28/2022	Printed			C029	CHARTER COMMUNICATIONS	ACCT#8245 12 895 0008281	514.78
36266	02/28/2022	Printed			C010	CHERRYLAND ELECTRIC COOP	ACCT#9823810	104.80
36267	02/28/2022	Printed			C040	CONSUMERS ENERGY	ACCT#1000 2967 1540	4,738.76
36268	02/28/2022	Printed			M020	DTE ENERGY	ACCT#9100 215 4419 2	1,853.65
36269	02/28/2022	Printed			E013	ELEVATE NET	MARINA PHONE	149.97
36270	02/28/2022	Printed			M008	GFL ENVIRONMENTAL	ACCT#002119662	113.87
36271	02/28/2022	Printed			G200	GRAND TRAVERSE COUNTY	ELMWOOD GREILICKVILLE WATER	69,438.30
36272	02/28/2022	Printed			G425	GUARDIAN	GROUP ID 00 357534	482.32
36273	02/28/2022	Printed			P043	PRIORITY HEALTH	GROUP ID 790105	5,230.85
36274	02/28/2022	Printed			V023	VSP	CLIENT ID 30031936	297.59

	<b>Total Checks: 12</b>		<b>Checks Total (excluding void checks):</b>	<b>83,536.03</b>
	<b>Total Payments: 12</b>		<b>Bank Total (excluding void checks):</b>	<b>83,536.03</b>
	<b>Total Payments: 12</b>		<b>Grand Total (excluding void checks):</b>	<b>83,536.03</b>

## Check Register Report

Emp. Code Desc.: 01  
ELMWOOD TWP

Date: 3/8/2022  
Time: 11:06:58

Check No.	Check Date	Recon.Date	Status	Employee ID	Pay To	Check Description	Amount
36212	02/10/2022	03/02/2022	R	00053	Duane Merritt	February 10, 2022	\$217.76
36213	02/10/2022	03/02/2022	R	SDU	MiSDU	Remittance Check	\$147.82
36214	02/10/2022	03/02/2022	R	VOY	Voya Institutional Trust Co.	Remittance Check	\$1,102.67
36215	02/15/2022	03/02/2022	R	00003	Deborah Allen	February 15, 2022	\$251.45
36216	02/15/2022	03/02/2022	R	00056	Terry Lautner	February 15, 2022	\$263.58
36217	02/15/2022		P	00001	Jeffrey Aprill	February 15, 2022	\$74.89
36218	02/15/2022	03/02/2022	R	00077	Frederick Bechtold Jr.	February 15, 2022	\$101.58
36219	02/15/2022	03/02/2022	R	00055	Carrie Schaub	February 15, 2022	\$687.44
36220	02/15/2022	03/02/2022	R	VOY	Voya Institutional Trust Co.	Remittance Check	\$478.00
36258	02/24/2022	03/02/2022	R	00053	Duane Merritt	February 22, 2022	\$205.66
36259	02/24/2022	03/02/2022	R	SDU	MiSDU	Remittance Check	\$147.82
36260	02/28/2022		P	AFLAC	AFLAC	Remittance Check	\$335.28
36261	02/28/2022		P	PFIA	PFIA	Remittance Check	\$38.62
36262	02/28/2022		P	VOY	Voya Institutional Trust Co.	Remittance Check	\$1,567.22
36275	03/10/2022		P	00053	Duane Merritt	March 10, 2022	\$248.01
36276	03/08/2022		P	SDU	MiSDU	Remittance Check	\$147.82
83241	02/10/2022		P	00083	Carrie Schaub	February 10, 2022	\$1,048.47
83242	02/10/2022		P	00032	Andrew Bakker	February 10, 2022	\$379.89
83243	02/10/2022		P	00035	Benjamin Bakker	February 10, 2022	\$2,026.38
83244	02/10/2022		P	00180	Benjamin Bakker	February 10, 2022	\$206.57
83245	02/10/2022		P	00157	Jay Davis	February 10, 2022	\$1,792.86
83246	02/10/2022		P	00195	Jay Davis	February 10, 2022	\$209.61
83247	02/10/2022		P	00143	Erin Goodrich	February 10, 2022	\$1,763.84
83248	02/10/2022		P	00163	Erin Goodrich	February 10, 2022	\$206.33
83249	02/10/2022		P	00216	Madeline Hall	February 10, 2022	\$262.47
83250	02/10/2022		P	00111	Matthew Johnson	February 10, 2022	\$1,533.63
83251	02/10/2022		P	00140	Matthew Johnson	February 10, 2022	\$191.88
83252	02/10/2022		P	00189	Jacob Kuiper	February 10, 2022	\$1,326.51
83253	02/10/2022		P	00210	Shirl Martin	February 10, 2022	\$153.37
83254	02/10/2022		P	00160	Daniel Mosholder	February 10, 2022	\$94.24
83255	02/10/2022		P	00186	Jason Newfer	February 10, 2022	\$1,401.90
83256	02/10/2022		P	00212	Robert Sokolnicki	February 10, 2022	\$1,883.83
83257	02/10/2022		P	184	Sara Sokolnicki	February 10, 2022	\$95.94
83258	02/10/2022		P	00109	Landon VanderRoest	February 10, 2022	\$1,813.01
83259	02/10/2022		P	00114	Landon VanderRoest	February 10, 2022	\$191.99
83260	02/10/2022		P	00126	Abigail VanRaalte	February 10, 2022	\$1,361.02
83261	02/10/2022		P	00102	Alex Werly	February 10, 2022	\$1,285.57
83262	02/10/2022		P	00178	Alex Werly	February 10, 2022	\$7.91
83263	02/10/2022		P	00022	Colleen Gallagher	February 10, 2022	\$581.02
83264	02/10/2022		P	IRSEF	IRSEFT	Remittance Check	\$6,632.20
83265	02/15/2022		P	209	David Darga	February 15, 2022	\$251.45
83266	02/15/2022		P	00089	James O'Rourke	February 15, 2022	\$251.45
83267	02/15/2022		P	00130	Jeffrey Shaw	February 15, 2022	\$1,892.25
83268	02/15/2022		P	00072	Keith Tampa	February 15, 2022	\$2,085.12
83269	02/15/2022		P	00098	Barbara Jones	February 15, 2022	\$1,603.78
83270	02/15/2022		P	00095	Connie Preston	February 15, 2022	\$1,733.07
83271	02/15/2022		P	00155	Chris Mikowski	February 15, 2022	\$1,520.19
83272	02/15/2022		P	00187	Jonah Kuzma	February 15, 2022	\$78.50
83273	02/15/2022		P	00198	Kendra Luta	February 15, 2022	\$74.89
83274	02/15/2022		P	00208	Nathan McDonald	February 15, 2022	\$78.50
83275	02/15/2022		P	00029	Sarah Clarren	February 15, 2022	\$1,961.90
83276	02/15/2022		P	00116	Peter Moon	February 15, 2022	\$1,402.03
83277	02/15/2022		P	IRSEF	IRSEFT	Remittance Check	\$4,906.09
83278	02/24/2022		P	00083	Carrie Schaub	February 22, 2022	\$1,048.47
83279	02/24/2022		P	00032	Andrew Bakker	February 22, 2022	\$158.87
83280	02/24/2022		P	00035	Benjamin Bakker	February 22, 2022	\$1,838.07
83281	02/24/2022		P	00180	Benjamin Bakker	February 22, 2022	\$206.57

# Check Register Report

Emp. Code Desc.: 01  
ELMWOOD TWP

Date: 3/8/2022  
Time: 11:06:58

Check No.	Check Date	Recon.Date	Status	Employee ID	Pay To	Check Description	Amount
83282	02/24/2022		P	00157	Jay Davis	February 22, 2022	\$1,814.02
83283	02/24/2022		P	00195	Jay Davis	February 22, 2022	\$209.61
83284	02/24/2022		P	00143	Erin Goodrich	February 22, 2022	\$675.98
83285	02/24/2022		P	00163	Erin Goodrich	February 22, 2022	\$392.41
83286	02/24/2022		P	00216	Madeline Hall	February 22, 2022	\$231.39
83287	02/24/2022		P	00111	Matthew Johnson	February 22, 2022	\$1,757.68
83288	02/24/2022		P	00140	Matthew Johnson	February 22, 2022	\$191.88
83289	02/24/2022		P	00189	Jacob Kuiper	February 22, 2022	\$1,326.51
83290	02/24/2022		P	00210	Shirl Martin	February 22, 2022	\$617.45
83291	02/24/2022		P	00160	Daniel Mosholder	February 22, 2022	\$39.26
83292	02/24/2022		P	00186	Jason Newfer	February 22, 2022	\$1,075.99
83293	02/24/2022		P	00212	Robert Sokolnicki	February 22, 2022	\$2,162.92
83294	02/24/2022		P	184	Sara Sokolnicki	February 22, 2022	\$155.77
83295	02/24/2022		P	00109	Landon VanderRoest	February 22, 2022	\$1,622.55
83296	02/24/2022		P	00114	Landon VanderRoest	February 22, 2022	\$191.99
83297	02/24/2022		P	00126	Abbigail VanRaalte	February 22, 2022	\$1,361.02
83298	02/24/2022		P	00102	Alex Werly	February 22, 2022	\$1,550.08
83299	02/24/2022		P	00178	Alex Werly	February 22, 2022	\$368.83
83300	02/24/2022		P	00022	Colleen Gallagher	February 22, 2022	\$554.78
83301	02/24/2022		P	00071	Sara Kopriva	February 22, 2022	\$22.47
83302	02/28/2022		P	00130	Jeffrey Shaw	February 28, 2022	\$1,892.25
83303	02/28/2022		P	00072	Keith Tampa	February 28, 2022	\$2,085.12
83304	02/28/2022		P	00098	Barbara Jones	February 28, 2022	\$1,603.78
83305	02/28/2022		P	00095	Connie Preston	February 28, 2022	\$1,733.07
83306	02/28/2022		P	00155	Chris Mikowski	February 28, 2022	\$1,464.01
83307	02/28/2022		P	00158	Aric Kuester	February 28, 2022	\$479.32
83308	02/28/2022		P	00029	Sarah Clarren	February 28, 2022	\$1,961.90
83309	02/28/2022		P	00116	Peter Moon	February 28, 2022	\$1,402.03
83310	02/28/2022		P	IRSEF	IRSEFT	Remittance Check	\$11,168.33
83311	02/28/2022		P	MICH	State of Michigan Tax	Remittance Check	\$3,451.55
83312	03/10/2022		P	00083	Carrie Schaub	March 10, 2022	\$1,048.47
83313	03/10/2022		P	00032	Andrew Bakker	March 10, 2022	\$457.93
83314	03/10/2022		P	00035	Benjamin Bakker	March 10, 2022	\$1,227.78
83315	03/10/2022		P	00180	Benjamin Bakker	March 10, 2022	\$206.57
83316	03/10/2022		P	00157	Jay Davis	March 10, 2022	\$1,623.60
83317	03/10/2022		P	00195	Jay Davis	March 10, 2022	\$209.61
83318	03/10/2022		P	00143	Erin Goodrich	March 10, 2022	\$520.18
83319	03/10/2022		P	00216	Madeline Hall	March 10, 2022	\$221.03
83320	03/10/2022		P	00111	Matthew Johnson	March 10, 2022	\$1,504.14
83321	03/10/2022		P	00140	Matthew Johnson	March 10, 2022	\$191.88
83322	03/10/2022		P	00189	Jacob Kuiper	March 10, 2022	\$1,434.15
83323	03/10/2022		P	00210	Shirl Martin	March 10, 2022	\$131.47
83324	03/10/2022		P	00160	Daniel Mosholder	March 10, 2022	\$31.41
83325	03/10/2022		P	00186	Jason Newfer	March 10, 2022	\$1,522.87
83326	03/10/2022		P	00212	Robert Sokolnicki	March 10, 2022	\$1,907.94
83327	03/10/2022		P	184	Sara Sokolnicki	March 10, 2022	\$66.02
83328	03/10/2022		P	00109	Landon VanderRoest	March 10, 2022	\$2,259.57
83329	03/10/2022		P	00114	Landon VanderRoest	March 10, 2022	\$191.99
83330	03/10/2022		P	00126	Abbigail VanRaalte	March 10, 2022	\$1,199.65
83331	03/10/2022		P	00102	Alex Werly	March 10, 2022	\$1,593.27
83332	03/10/2022		P	00178	Alex Werly	March 10, 2022	\$198.26
83333	03/10/2022		P	00022	Colleen Gallagher	March 10, 2022	\$549.65

**Total Checks: 109**

**Sub-Total: \$115,418.65**  
**Total Void/Stop Payment: \$0.00**  
**Grand Total: \$115,418.65**

## Supervisor's Report

3/14/22

1. Remodeling of the Cherry Bend Pavilion will start in a couple of weeks (weather dependent).
2. I attended the Broadband informational meeting at the County. The new fiberoptic system that will begin to be installed this year will cover all addresses in Elmwood Township, including the ones that currently have no service. The total cost for the project is 17 million dollars. Point Broadband will be putting in 12 million and the County has pledged 5 million. 3.2 million will come from the ARPA money the County received. They will be looking for grants to make up the remaining 1.8 million. They will probably be coming to the Townships to look for partnerships as well.
3. Chuck Korn, supervisor of Garfield Township, has proposed Elmwood Township consider building a Water Treatment facility on West Bay. The Traverse City Area is currently served by the Traverse City facility on East Bay. EGLE would like to see some redundancy, so they would probably be in support of such a project. The city system has no competition, so we in Elmwood, as well as all the other users of the current system, have to pay whatever the city charges. This would obviously be a major project, and if interest gains any traction, we may want to talk about it at the Board level.
4. I am in the process of setting up a meeting with Timberlee water users to discuss their options regarding the EGLE upgrades to their system. Jamie Wade from EGLE, John Divozzo from the Grand Traverse County Department of Public Works, and Brian Sousa from Wade Trim will all be participating in the meeting.



CHARTER TOWNSHIP OF ELMWOOD  
RESOLUTION #1 OF 2022  
CAPITAL PURCHASE POLICY

At a regular meeting of the Board of the Charter Township of Elmwood, held in the Township Hall located at 10090 E. Lincoln Rd. Traverse City Michigan, on the 14<sup>th</sup> day of March, 2022 there were

PRESENT:  
EXCUSED:

The following resolution was offered by \_\_\_\_\_ and seconded by \_\_\_\_\_.

WHEREAS the Township Board has final authority to approve appropriations of all funds within the Township and,

WHEREAS MCL 141.422 Sec. 2b[e] designates responsibility for the control of the Township Budget and,

WHEREAS the Township Board wishes to replace the Capital Purchase Appropriations Policy that was adopted on January 13, 2003 and amended on December 12, 2011

NOW THEREFORE BE IT RESOLVED that all capital purchases within any department exceeding \$3000.00 shall have prior authorization from the Township Board before the purchase is completed and

BE IT FURTHER RESOLVED that all capital purchases exceeding \$3000.00 require three (3) written bids from which the Township Board may make an informed decision to promote fiscal responsibility within the Township.

Upon a roll call vote, the following voted:

YES:  
NO:

RESOLUTION DECLARED ADOPTED

\_\_\_\_\_  
Jeff Shaw, Supervisor

I, the undersigned, the Clerk of the Charter Township of Elmwood, Leelanau County, Michigan, do hereby certify that the foregoing is a true and complete copy of certain proceedings taken by the Township Board of said municipality at its regular meeting held on March 14, 2022 relative to adoption of the resolution therein set forth; that said meeting was conducted and public notice of said meeting was given pursuant to and in full compliance with the Open Meetings Act, being Act 267, Public Acts of Michigan, 1976, and that the minutes of said meeting were kept and will be or have been made available as required by said Act.

Dated: March 14, 2022

\_\_\_\_\_  
Connie Preston, Clerk

CHARTER TOWNSHIP OF ELMWOOD  
COUNTY OF LEELANAU  
RESOLUTION #14 OF 2011

RESOLUTION TO AMEND THE CAPITAL PURCHASE POLICY

At a regular meeting of the Board of the Charter Township of Elmwood, held in the Township Hall in the Township of Elmwood, County of Leelanau, Michigan, on December 12, 2011 there were

PRESENT: Debbie Street, Terry Lautner, Jack Kelly, Mary Barrows, and Dave Darga  
EXCUSED: Connie Preston and Don Gallagher

The following resolution was offered by Trustee Barrows, and seconded by Treasurer Street.

WHEREAS the Township Board has final authority to approve appropriations of all funds within the township and

WHEREAS MCL 141.422 Sec. 2b(e) designates responsibility for the control of the township budget

WHEREAS the Township Board adopted a Capital Purchase policy on Jan 13, 2003 and now wishes to amend that policy,

NOW THEREFORE BE IT RESOLVED that all capital purchases within any department exceeding \$1000.00 shall have prior authorization from the Township Board before the purchase is completed and,

BE IT FURTHER RESOLVED that all capital purchases exceeding \$1000.00 require three (3) written bids from which the Township Board may make an informed decision to promote fiscal responsibility within the Township.

Upon a roll call vote, the following voted

AYE: Street, Lautner, Kelly, Barrows, and Darga  
NAY: None

RESOLUTION DECLARED ADOPTED

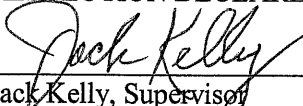
  
\_\_\_\_\_  
Jack Kelly, Supervisor

I, the undersigned, the Clerk of the Charter Township of Elmwood, Leelanau County, Michigan, do hereby certify that the foregoing is a true and complete copy of certain proceedings taken by the Elmwood Charter Township Board of said municipality at a regular meeting held on December 12, 2011, relative to adoption of the resolution therein set forth; that said meeting was conducted and public notice of said meeting was given pursuant to and in full compliance with the Open Meetings Act, being Act 267, Public Acts of Michigan, 1976, and that the minutes of said meeting were kept and will be or have been made available as required by said Act,

Dated: December 12, 2011

  
\_\_\_\_\_  
Connie Preston, Clerk

RESOLUTION #2003-2  
CAPITAL PURCHASE APPROPRIATIONS

WHEREAS the Township Board has final authority to approve appropriations of all funds within the township and

WHEREAS MCL 141.422 Sec. 2b[e] designates responsibility for the control of the township budget ,

NOW, THEREFORE, BE IT RESOLVED that all capital purchases within any department exceeding \$500.00 shall have prior authorization from the Township Board before the purchase is completed and

BE IT FURTHER RESOLVED that all capital purchases exceeding \$500.00 require three (3) written bids from which the Township Board may make an informed decision to promote fiscal responsibility within the Township.

The foregoing resolution offered by Board Member Gallagher and seconded by Board Member Street.

Upon roll call vote the following voted AYE; Gallagher, Street, O'Rourke, Lawden, Stanek, Flohr, + Preston  
NAY None

ABSENT None

The Supervisor declared the resolution adopted.

Connie M Preston -

Connie Preston

Elmwood Township Clerk

1-13-03

CREDIT CARD USE POLICY

- (a) The clerk is responsible for issuing, accounting for, monitoring, retrieving and generally overseeing compliance with the township's credit card policy.
- (b) Township credit cards may be used only by an officer or employee of the township for the purchase of goods or services for the official business of the township. The maximum expenditure by any one individual at any one time is \$1000.00
- (c) Township officers and employees who use a township credit card shall submit to the clerk documentation detailing the goods or services purchased, the cost of the goods or services, the date of the purchase, and the official business for which purchased. The use of a township credit card is authorized for department heads to make purchases of goods and services for the benefit of the township by electronic means, including the internet. Provided further, however, that any such expenditure shall not exceed \$1000.00 at any one time, and shall not exceed a cumulative total in any one calendar month greater than \$5000.00
- (d) An official or employee who is issued a credit card is responsible for its protection and custody. If a credit card is lost or stolen, the township officer described in (a) above shall be notified. The entity issuing the lost or stolen credit card shall be immediately notified to cancel the card.
- (e) An officer or employee issued a credit card shall return the credit card to the township officer described in (a) above upon termination of his or her employment or service with the township.
- (f) The township officer described in (a) above shall maintain a list of all credit cards owned by the township, along with the name of the officer and employee who has been issued the credit card, the credit limit established, the date issued, and the date returned. Each employee shall initial the list beside his or her name to indicate agreement that the credit card has been issued, and that the employee has received and read a copy of this policy. The township clerk and the treasurer shall review each credit card statement as soon as possible to ensure that transactions comply with this policy. After review the officers shall initial the invoice. Any transactions that appear on the statements that are not documented with a credit card slip or a signed voucher shall be immediately investigated. Transactions that do not appear to comply with this policy shall be reported to the township board.
- (g) The township board shall not approve a payment to the entity issuing the credit card until all transactions have been verified, including the approval of all transaction invoices if issued.
- (h) The balance including interest due on an extension of credit under the credit card arrangement shall be paid for within not more than 60 days of the initial statement date. The Township of Elmwood shall comply with payment provisions of the credit card policy to the extent reasonably possible, but in no event shall any payment for the extension of credit by use of the credit card be made more than 60 days from the date of the initial statement.
- (i) Officers and employees who use a township credit card in a manner contrary to this policy shall be subject to the following disciplinary actions, or a combination of the actions, such as both a suspension and a requirement for reimbursement, as deemed appropriate by the township board:

- verbal counseling
- written reprimand
- suspension
- termination

reimbursement to the township for unauthorized expenditures.

(j) The limit of outstanding charges on any credit card shall be \$5000.00

Adopted 6-13-2006

Proposed

## CREDIT CARD USE POLICY

- (a) The clerk is responsible for issuing, accounting for, monitoring, retrieving and generally overseeing compliance with the township's credit card policy.
- (b) Township credit cards may be used only by an officer or employee of the township for the purchase of goods or services for the official business of the township. The maximum expenditure by any one individual at any one time is \$3000.00
- (c) Township officers and employees who use a township credit card shall submit to the clerk documentation detailing the goods or services purchased, the cost of the goods or services, the date of the purchase, and the official business for which purchased. The use of a township credit card is authorized for department heads to make purchases of goods and services for the benefit of the township by electronic means, including the internet. Provided further, however, that any such expenditure shall not exceed \$3000.00 at any one time, and shall not exceed a cumulative total in any one calendar month greater than \$5000.00
- (d) An official or employee who is issued a credit card is responsible for its protection and custody. If a credit card is lost or stolen, the township officer described in (a) above shall be notified. The entity issuing the lost or stolen credit card shall be immediately notified to cancel the card.
- (e) An officer or employee issued a credit card shall return the credit card to the township officer described in (a) above upon termination of his or her employment or service with the township.
- (f) The township officer described in (a) above shall maintain a list of all credit cards owned by the township, along with the name of the officer and employee who has been issued the credit card, the credit limit established, the date issued, and the date returned. Each employee shall initial the list beside his or her name to indicate agreement that the credit card has been issued, and that the employee has received and read a copy of this policy. The township clerk and the treasurer shall review each credit card statement as soon as possible to ensure that transactions comply with this policy. After review the officers shall initial the invoice. Any transactions that appear on the statements that are not documented with a credit card slip or a signed voucher shall be immediately investigated. Transactions that do not appear to comply with this policy shall be reported to the township board.
- (g) The township board shall not approve a payment to the entity issuing the credit card until all transactions have been verified, including the approval of all transaction invoices if issued.
- (h) The balance including interest due on an extension of credit under the credit card arrangement shall be paid for within not more than 60 days of the initial statement date. The Township of Elmwood shall comply with payment provisions of the credit card policy to the extent reasonably possible, but in no event shall any payment for the extension of credit by use of the credit card be made more than 60 days from the date of the initial statement.
- (i) Officers and employees who use a township credit card in a manner contrary to this policy shall be subject to the following disciplinary actions, or a combination of the actions, such as both a suspension and a requirement for reimbursement, as deemed appropriate by the township board:
- verbal counseling
  - written reprimand
  - suspension
  - termination

reimbursement to the township for unauthorized expenditures.

(j) The limit of outstanding charges on any credit card shall be \$5000.00

Adopted 6-13-2006

**ELMWOOD CHARTER TOWNSHIP FEE ORDINANCE**  
**Ordinance No. \_\_\_\_ of 2022**

AN ORDINANCE TO ESTABLISH TOWNSHIP FEES

THE CHARTER TOWNSHIP OF ELMWOOD ORDAINS:

**Section 1. Legislative Findings.**

The Elmwood Charter Township Board hereby finds that Section 15 of the Charter Township Act, MCL 42.15, provides that the township board of any charter township may by ordinance provide for reasonable fees that the board considers necessary and proper. The Elmwood Charter Township Board, however, finds there is often a need to add fees and change the amount of those fees as circumstances may dictate. The Board further finds that establishing reasonable fees by resolution is a more cost-effective method of updating the necessary fees. Therefore, the Board finds that this Ordinance is intended to comply with the ordinance requirement of Section 15 of the Charter Township Act, while at the same time providing the Board flexibility in establishing the necessary fees by resolution.

**Section 2. Establishment of Necessary Fees.**

The Elmwood Charter Township Board is hereby authorized to establish and update from time to time by resolution reasonable fees that the Board considers necessary and proper in connection with processing zoning and nonzoning applications, holding public hearings, and providing various township services.

**Section 3. Repeal.**

The Elmwood Charter Township Ordinance 96-121, entitled Fees for Processing Zoning and Land Use Requests is hereby repealed in its entirety.

**Section 4. Effective Date.**

This Ordinance shall become effective the day following its publication by the Township as required by Section 8 of the Charter Township Act, MCL 42.8.



Ordinance No. \_\_\_\_\_ was adopted on the \_\_\_\_\_ day of \_\_\_\_\_, 2022,  
by the Elmwood Charter Township Board as follows:

Motion by: \_\_\_\_\_  
Seconded by: \_\_\_\_\_  
Yeas: \_\_\_\_\_  
Nays: \_\_\_\_\_  
Absent: \_\_\_\_\_

\_\_\_\_\_  
Connie M. Preston, Clerk

\_\_\_\_\_  
Jeff Shaw, Supervisor

I certify that this is a true copy of Ordinance No. \_\_\_\_\_ that was adopted at a regular  
meeting of the Elmwood Charter Township Board on \_\_\_\_\_, 2022  
and published in the *Traverse City Record Eagle* on \_\_\_\_\_, 2022.

Dated: \_\_\_\_\_

\_\_\_\_\_  
Connie M. Preston, Clerk

To: Elmwood Township Board

From: Sarah Clarren, Planner/Zoning Administrator

RE: Planning Commission Request for Further Clarification

Date: 3/7/2022

---

At the Board's last meeting, they discussed a request for clarification from the Planning Commission on what the Board meant by the 'Greilickville neighborhoods' in your below motion made on September 30, 2021:

MOTION BY CLERK PRESTON, SECONDED BY TRUSTEE DARGA TO DIRECT THE PLANNING COMMISSION AS SOON AS POSSIBLE TO REMOVE STRS FROM SUBDIVISIONS IN GREILICKVILLE NEIGHBORHOODS USING AN OVERLAY DISTRICT OR AMENDMENT TO THE ZONING DISTRICTS. A roll call vote yielded ayes from Lautner, Allen, O'Rourke, Darga, and Preston and nays from Shaw and Mikowski.

Since your last meeting, I have produced the requested map showing all valid STR applications the Township has received as of 3/3/2022, which is enclosed with this memo. This map includes the 75 licenses I have issued to date as well as three applications that are still 'pending.' As relayed at your last meeting, I would discourage the Board to make any decision on the boundaries of a neighborhood based on the map of the STR locations.

If the Board remains interested in having the Planning Commission pursue an overlay district, please provide requested clarification on the bounds of 'Greilickville neighborhoods.'

In order to aid your discussion on what was meant by the 'Greilickville neighborhoods,' in your above referenced motion I have enclosed the following:

1. ZA Memo dated 2/8/2022 which includes:
  - a. Elmwood Township's current Zoning District Map
  - b. Elmwood Township's Future Land Use Map (includes 'Greilickville Service Center')
  - c. An undated map of Elmwood Township's Subdivisions & Site Condominiums, as provided by a member of the public (which was obtained from the County)
  - d. HB-4722, as passed



Bingham Township

West Grand Traverse Bay

Solon Township

Grand Traverse County

### Zoning Districts

- STRs
- Agricultural - Rural (A-R)
- Residential 1 (R-1)
- Residential 2 (R-2)
- Residential 3 (R-3)
- Manufactured Home Park (MHP)
- Rural Resort (RR)
- Municipal Center (MC)
- Neighborhood Commercial (NC)
- General Commercial (GC)
- Light Industrial (LI)
- Shoreline Commercial (SC)
- Conditional Rezoning

### STRs Within Elmwood 3/3/2022

N

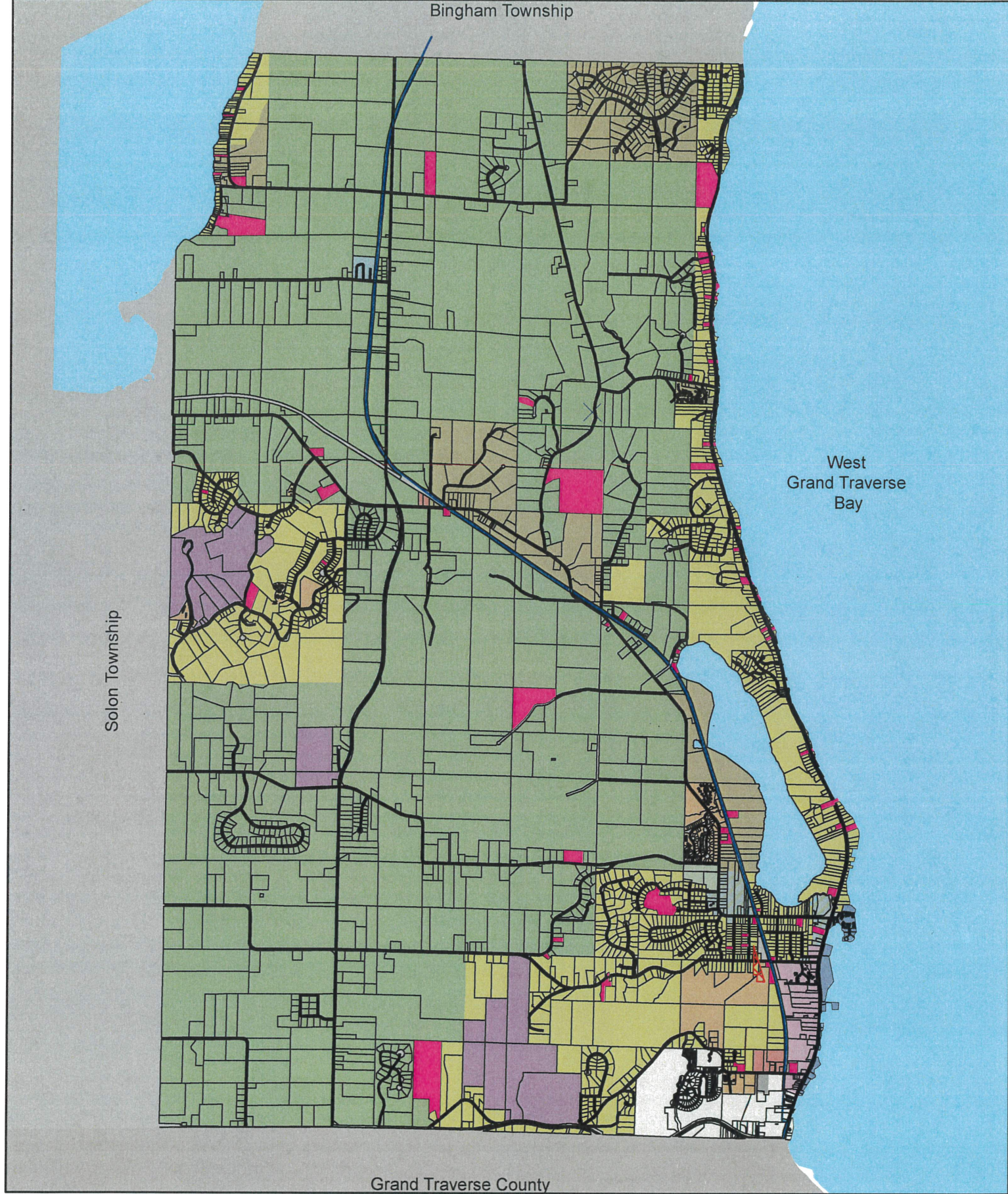



To: Elmwood Township Board  
From: Sarah Clarren, Planner/Zoning Administrator  
RE: Planning Commission Request for Further Clarification  
Date: 2/8/2022

---

Among other items of business, on September 30, 2021, the Township Board made the following motions:

MOTION BY TRUSTEE LAUTNER, SECONDED BY TRUSTEE ALLEN TO APPROVE ORDINANCE AMENDMENT 2021-3 WITH THE CHANGES IN THE 2ND LINE OF THE DEFINITION. A roll call vote yielded ayes from O'Rourke, Allen, Lautner, Mikowski, and Shaw and Nays from Darga and Preston. The motion passed 5-2

MOTION BY TRUSTEE O'ROURKE, SECONDED BY TRUSTEE ALLEN TO ADOPT ORDINANCE 2021-2 WITH THE MODIFICATIONS MADE TONIGHT. A roll call vote yielded ayes from Lautner, Preston, Mikowski, Allen, O'Rourke, and Shaw and Nay from Darga. The motion passed 6-1.

MOTION BY CLERK PRESTON, SECONDED BY TRUSTEE DARGA TO DIRECT THE PLANNING COMMISSION AS SOON AS POSSIBLE TO REMOVE STRS FROM SUBDIVISIONS IN GREILICKVILLE NEIGHBORHOODS USING AN OVERLAY DISTRICT OR AMENDMENT TO THE ZONING DISTRICTS. A roll call vote yielded ayes from Lautner, Allen, O'Rourke, Darga, and Preston and nays from Shaw and Mikowski.

It is worth noting to the Board that since September 30<sup>th</sup>, 2021, the following has occurred:

1. On 10/27/21, House Bill-4722 passed the House which if signed in to law would amend the MI Zoning Enabling Act and limit the Township's ability to regulate STRs. To-date, the Bill has not been passed by the MI Senate. The last action on HB-4722 was on 10/27/2021 when it was referred to the Committee on Regulatory Reform.
2. The Zoning Administrator has issued 73 of the 93 allowed licenses.

On November 9<sup>th</sup>, 2021, the Planning Commission discussed the Board's motion regarding the creation of an overlay district and ultimately determined to hold off on discussion until at least January in order to determine what happens in the Legislature and to have further information on where the properties that submitted STR applications are located.

On January 18<sup>th</sup>, 2022, the Commission further discussed the Board's motion and determined that they would like further clarification from the Board on what the Board meant by the Greilickville neighborhoods. Once the area is further defined, the Commission also requested a map from the ZA showing locations of licensed STRs before concluding if they should move forward with pursuing an overlay district.

In order to aid your discussion on what was meant by the 'Greilickville neighborhoods,' in your above referenced motion I have enclosed the following:

1. Elmwood Township's current Zoning District Map
2. Elmwood Township's Future Land Use Map (includes 'Greilickville Service Center')
3. An undated map of Elmwood Township's Subdivisions & Site Condominiums, as provided by a member of the public (which was obtained from the County)
4. HB-4722, as passed



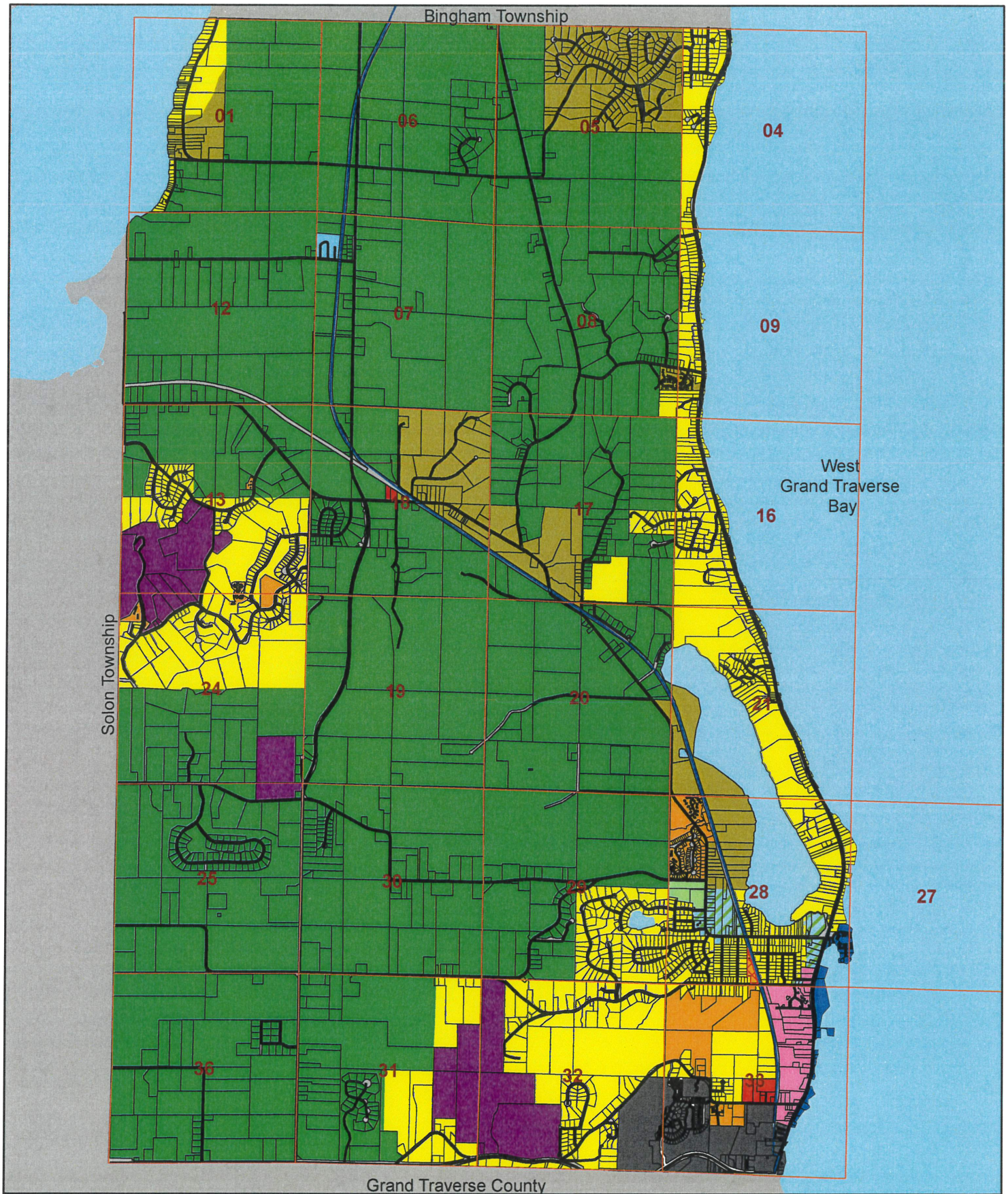

**Zoning Districts**

- |                            |                              |                           |                      |
|----------------------------|------------------------------|---------------------------|----------------------|
| Agricultural - Rural (A-R) | Manufactured Home Park (MHP) | General Commercial (GC)   | Conditional Rezoning |
| Residential 1 (R-1)        | Rural Resort (RR)            | Light Industrial (LI)     |                      |
| Residential 2 (R-2)        | Municipal Center (MC)        | Shoreline Commercial (SC) |                      |
| Residential 3 (R-3)        | Neighborhood Commercial (NC) | Traverse City             |                      |



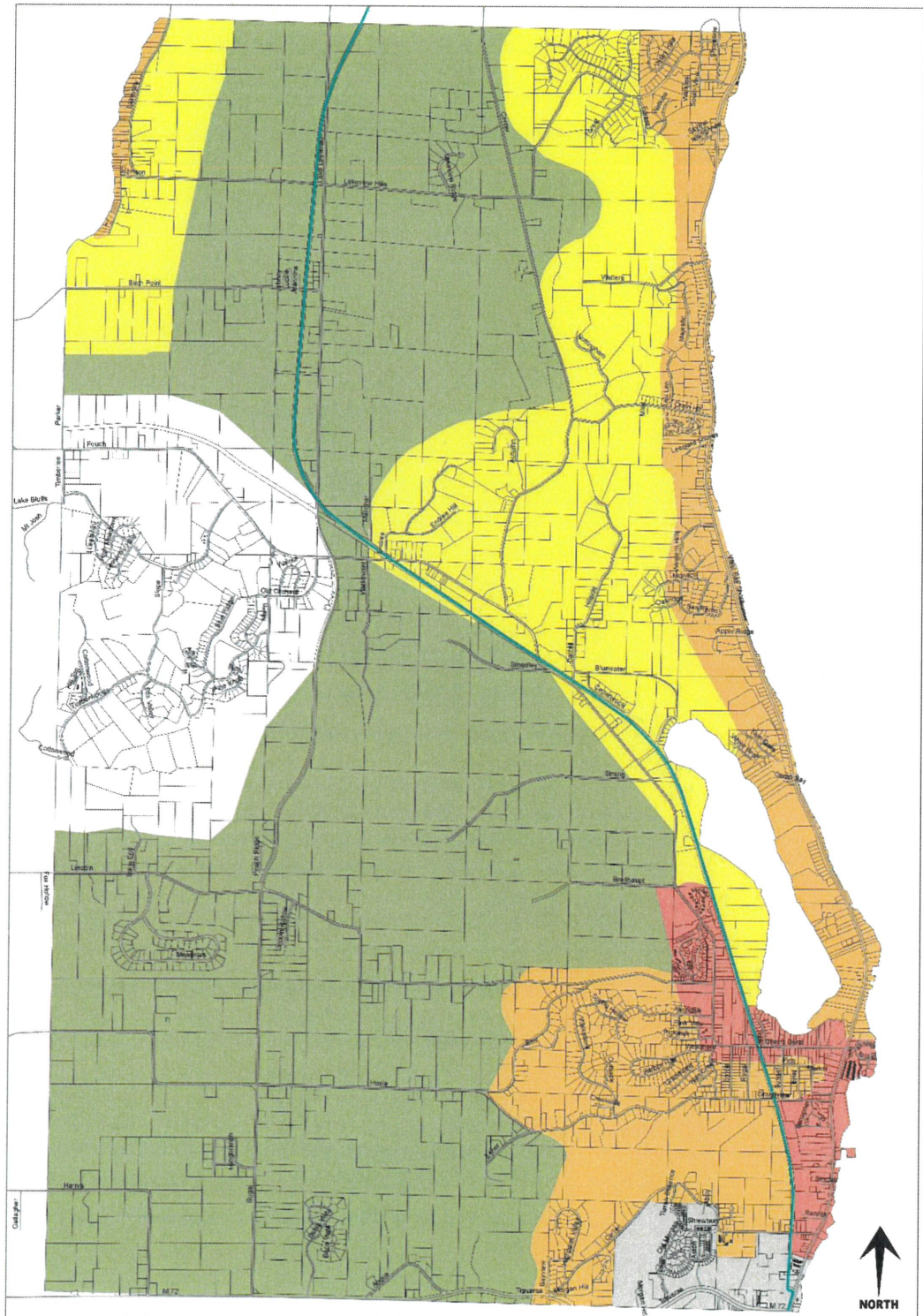

# CHARTER TOWNSHIP OF ELMWOOD

## FUTURE LAND USE MAP

- GREILICKVILLE SERVICE CENTER
- MEDIUM DENSITY RESIDENTIAL
- TIMBERLEE
- HIGH DENSITY RESIDENTIAL
- RURAL LOW DENSITY
- TRAVERSE CITY
- Tart Trail

Date: 4/8/2016





# Subdivisions & Site Condos

Elmwood Township, Leelanau County

Cherry Bend Area

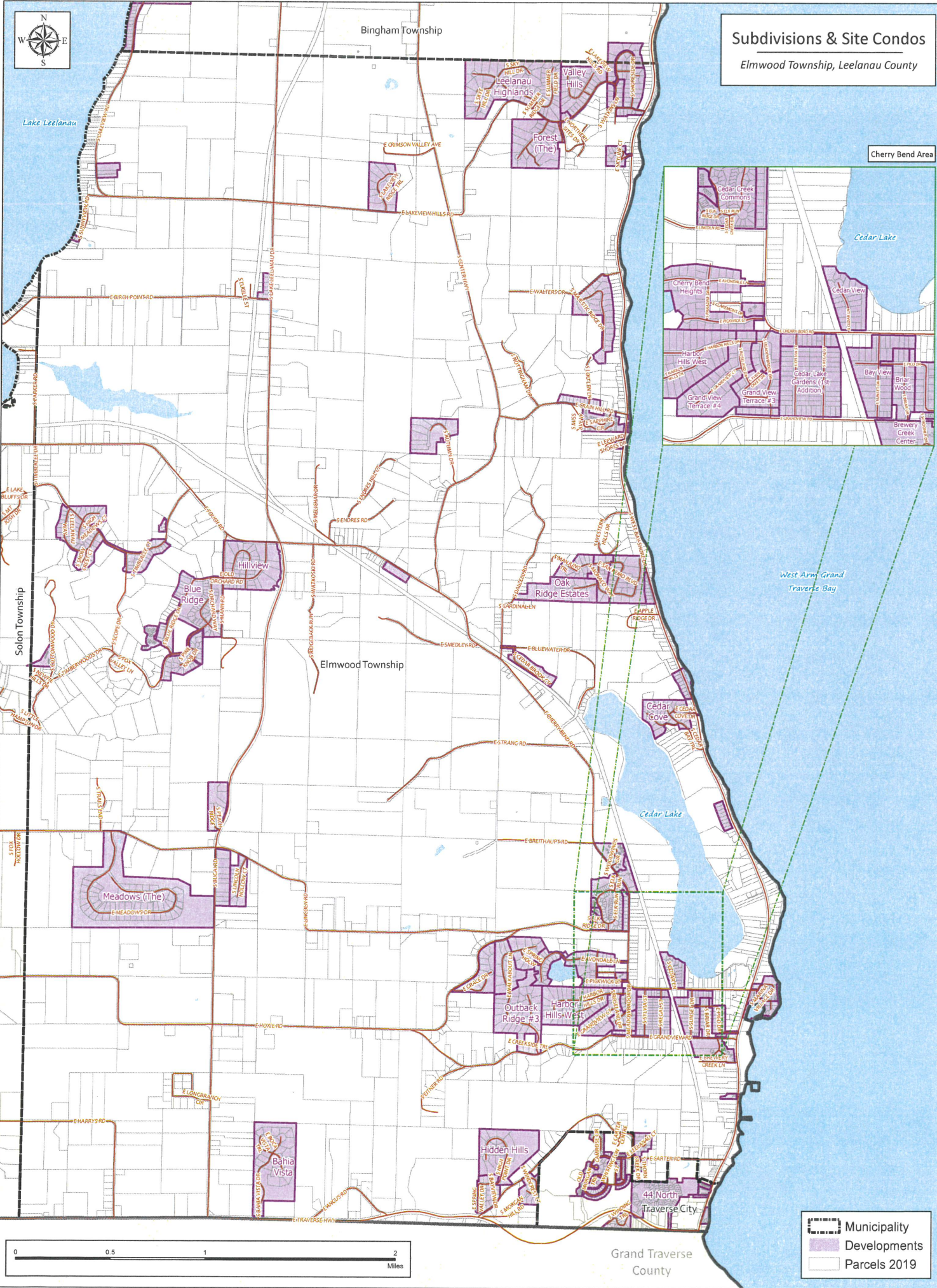

- Municipality
- Developments
- Parcels 2019

Grand Traverse County

The map is prepared by Leelanau County for reference purposes only. Leelanau County is not liable for any errors that may be found in this map.

Planning/ Zoning Department  
[planner@elmwoodtownship.net](mailto:planner@elmwoodtownship.net)

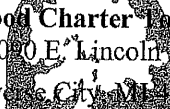
  
Elmwood Charter Township  
10020 E Lincoln Rd.  
Traverse City, MI 49684

Contact Information  
Ph: (231) 946-0921  
Fax: (231) 946-9320

---

To: Elmwood Township Board

From: Sarah Clarren

Date: February 11, 2022

RE: INTRODUCTION to **ZO 2017-04-12** – Setback and Special Use Standards Amendment

---

**Recommended Motion:** Motion to accept introduction and publish for consideration at the April 11, 2022 Township Board meeting.

---

At your August 9, 2021 meeting, members of the Township Board expressed concern over how the proposed amendment would impact any developments at Brewery Creek, or similar properties. As requested by the Board, Township Supervisor Jeff Shaw and myself walked the area with Township Engineer Brian Sousa. Sousa relayed that the majority of wetlands onsite are manmade, with the exception of the area to the north of the property, where the creek runs. Some of the site would be exempted from wetlands classification, but without a wetlands delineation it is difficult to determine said extent. That said, please note that if/when Brewery Creek is further developed, the Township may wish to consider submitting a Planned Development, which would allow some flexibility with zoning.

As requested by the Board, I have added language exempting certain lands that are wet, however, the Township cannot enact less strict regulations to wetlands. Therefore, to avoid any inconsistencies with State law, the language I propose is the following:

“Section 324.30305 of NREPA lists exemptions not subject to wetlands protection regulations. Elmwood Township shall not impose wetland setbacks on said exemptions. The applicant has the burden of proof for providing evidence of any exemption(s).”

I would not consider this to be a major change to the amendment that was recommended for approval by the Planning Commission on 5/26/21 as it ensures compliance between Township regulations and State Law. I have enclosed Section 324.30305 so the Board knows the exemptions.

It may be worth noting that the language found in the proposed amendment regarding Section 6.1.2.B.6 existed in the Pre-2017 Zoning Ordinance and was omitted by error. Further, the changes in the definition of ‘Water’s Edge’ clarifies what is currently in our Ordinance; our Ordinance defines Lot Line, Water as “The lot line that separates the lot from a body of water or stream. See also Water’s Edge.”

Wetlands are an invaluable resource that need to be protected. We touched briefly on their benefits at your last meeting, but I have included an EPA handout noting some of the Economic Benefits of Wetlands for your further reference.

Attached:

Ordinance 2017-04-12, with redlined proposed changes since last reviewed by Township Board;  
Excerpt of 324.30305 of the Natural Resources and Environmental Protection Act 451 of 1994;  
Economic Benefits of Wetlands Handout (produced by the EPA).



CHARTER TOWNSHIP OF ELMWOOD  
Leelanau County, Michigan

Ordinance No. \_\_\_\_\_  
ZO 2017-04-12

AN ORDINANCE TO AMEND THE TOWNSHIP ZONING ORDINANCE, IN ACCORDANCE WITH THE PROVISIONS OF THE MICHIGAN ZONING ENABLING ACT, ACT 110 OF THE PUBLIC ACTS OF 2006, AS AMENDED [MCL 125.3101 ET SEQ.], TO AMEND TABLE 5.6, ARTICLE 2, ARTICLE 6, AND ARTICLE 9.

The Charter Township of Elmwood Ordains:

**Section 1:** Amendment.

The following sections of the Elmwood Township Zoning Ordinance shall be amended to read as follows:

**A. Table 5.6 shall be amended to add a Wetlands Column with a 30 ft setback in all districts.**

District	Minimum Lot Requirements (See Note A)		Minimum Setback (ft.) (See Notes A, B, C, G)					Max. Height (ft.) (See Notes D, E)	
	Minimum Area	Width (ft.)	Wetlands	Water's Edge	Front	Sides	Rear		
A-R	1 acre	125	30	30	50	10	25	35	
R1	12,500 sq. ft.	100	30	30	30	10	25	35	
R-2	12,500 sq. ft.	100	30	30	30	10	25	35	
R-3	6,250 sq. ft.	100	30	30	30	10	25	35	
MHP	See Note F								
NC	W/public water or sewer***	20,000 sq. ft.	100	30	30	30	10	25	3 Stories
	W/out public water or sewer***	40,000 sq. ft. minimum	100	30	30	30	10	25	3 Stories
GC	12,500 sq. ft.	100	30	30*	30*	10	20	3 Stories	
LI	20,000 sq. ft.	100	30	30*	30*	10**	20	3 Stories	
SC	12,500 sq. ft.	100	30	30*	30*	10	30	35	
RR	Single Family Dwelling	5 acre	235	30	30	50	10	25	35
MC	12,500 sq ft	100	30	30	30	10	20	35	

Note G: Wetlands. Section 324.30305 of NREPA lists exemptions not subject to wetlands protection regulations. Elmwood Township shall not impose wetland setbacks on said exemptions. The applicant has the burden of proof for providing evidence of any exemption(s).

**B. Article 2 Water's Edge definition shall be amended to read:**

**Water's Edge, also Waterfront.** The ordinary high water mark or where an ordinary high water mark has not been established, the line between the upland and bottomland which persists through successive changes in water levels, below which the presence of action of the water is so common or recurrent that the character of the land is marked distinctly from the upland and is apparent in the soil itself, the configuration of the surface of the soil and the vegetation. For a stream, river or creek, the top of the bank of the channel. In the case of the presence of bluff, the shoreline setback shall be measured from the edge of the bluff.

**C. Article 6 shall be amendment to add Section 6.1.2 B. 6:**

**Section 6.1.2**

B. 6. Every parking lot or parking area shall be so constructed that no surface water shall shed into or towards such body of water unless such surface water is first treated or filtered to remove any silt, grease or oil, salt or other matter which would deteriorate the water quality of said body of water. Snow removal from parking lot or parking area shall not be stored within the water edge setback unless contained to the parking area.

**D. Section 9.3 B shall be removed in its entirety and Section 9.3 #9 shall be amended to read as follows:**

9. The following specific requirements shall be met to the extent applicable to the proposed special land use:

- a. Ingress and egress for the special land use shall be controlled to ensure maximum vehicular and pedestrian safety, convenience, and minimum traffic impact on adjacent roads and highways, drives, and nearby uses including, but not limited to:
  - i. Minimization of the number of ingress and egress points through elimination, minimization, and consolidation of drives and curb cuts;
  - ii. Proximity and relation of driveway to intersections;
  - iii. Minimization of pedestrian and vehicular traffic conflicts;
  - iv. Adequacy of sight distances between road and driveway intersections as specified in Section 6.2, Access Management.
  - v. Location and accessibility of off-street parking, loading, and unloading for automotive vehicles, including buses and trucks;
  - vi. Location and potential use of ingress and egress drives to access special land use parcels for the purpose of possibly reducing the number of access points necessary to serve the parcels.
  - vii. Adequate maneuverability and circulation for emergency vehicles.
- b. Screening shall be provided along all sides and rear property lines by a buffer area, and along the front property line by a greenbelt in accordance with Section 6.4, unless it can be demonstrated that the proposed special land use can be adequately

controlled through some other means, such as restrictions on the hours of operation, or reducing the impact by the type and level of activity to be conducted on the site.

**Section 2:** Severability.

If any sections, clause, or provision of this Ordinance is declared unconstitutional or otherwise invalid by a court of competent jurisdiction, said declaration shall not affect the remainder of the Ordinance. The Township Board hereby declares that it would have passed this Ordinance and each part, section, subsection, phrase, sentence and clause irrespective of the fact that any one or more parts, sections, subsections, phrases, sentences or clauses be declared invalid.

**Section 3:** Effective Date.

This Ordinance shall become effective eight (8) days following publication.

*CFR 233.53(c)(8)(vi) WITHDRAWING APPROVAL OF THE STATE PROGRAM UNDER 33 USC 1344(g) AND (h). (See enacting section 2 of Act 98 of 2013.) \*\*\*\*\**

**324.30304b Issuance of state programmatic general permits; agreement with United States army corps of engineers; applicability of subsections (2) and (3).**

Sec. 30304b. (1) The department shall pursue an agreement with the United States army corps of engineers for the corps to issue state programmatic general permits under section 404(e) of title IV of the federal water pollution control act, 33 USC 1344, for activities regulated under this part in waters over which the corps retains jurisdiction under section 404(g)(1) of title IV of the federal water pollution control act, 33 USC 1344.

(2) This subsection applies beginning January 1, 2011. This subsection applies to an application for a permit under this part only if the application is for an activity or use in waters over which the corps retains jurisdiction under section 404(g)(1) of title IV of the federal water pollution control act, 33 USC 1344, and if the corps has not issued a state programmatic general permit for the activity or use. In such a case, if requested by the applicant in the application, all of the following apply:

(a) The department shall approve or deny the application for a permit under this part not more than 30 days after the corps grants or denies an application for a permit for the project under section 404(a) of title IV of the federal water pollution control act, 33 USC 1344, or by the end of the processing period otherwise provided for in section 1301, whichever is later. If a project proposed in a permit application processed under this subsection also requires authorization under 1 or more of parts 31, 301, 315, 323, 325, or 353, the requirements of this subdivision also apply to the department's decision under that part or parts.

(b) Subject to subsection (3), if the corps grants a permit for the project, the department shall grant a permit under this part without conditions or limitations other than those imposed by the corps unless any of the following apply:

(i) The wetland is a rare and imperiled wetland.

(ii) The wetland is regionally significant for the protection of fisheries, wildlife, or migratory birds.

(iii) The site is described in section 30309(a), (e), or (g).

(iv) The proposed project involves a use or activity not regulated under section 404(a) of title IV of the federal water pollution control act, 33 USC 1344.

(3) The department shall inform the applicant in writing of the basis for a finding that the requirements of subsection (2)(b)(i), (ii), (iii), or (iv) are met and the specific reasons why denial of the permit or the imposition of additional conditions or limitations on the permit is consistent with this part and rules promulgated under this part.

(4) Subsections (2)(b) and (3) apply only to the department's decision under this part notwithstanding that the project proposed in the application also requires authorization under 1 or more of parts 31, 301, 315, 323, 325, and 353.

**History:** Add. 2009, Act 120, Eff. Nov. 6, 2009.

**Compiler's note:** Enacting section 1 of Act 120 of 2009 provides:

"Enacting section 1. This amendatory act does not take effect unless both of the following requirements are met:

"(a) \$4,000,000.00 from the cleanup and redevelopment trust fund created in section 3e of 1976 IL 1, MCL 445.573e, and \$4,000,000.00 from the community pollution prevention fund created in section 3f of 1976 IL 1, MCL 445.573f, is appropriated by the legislature to the environmental protection fund created in section 503a of the natural resources and environmental protection act, 1994 PA 451, MCL 324.503a.

"(b) \$2,000,000.00 is appropriated by the legislature from the environmental protection fund to support the program under part 303 of the natural resources and environmental protection act, 1994 PA 451, MCL 324.30301 to 324.30329."

**Popular name:** Act 451

**Popular name:** NREPA

**Popular name:** Wetland Protection Act

**\*\*\*\*\* 324.30305 THIS SECTION IS REPEALED BY ACT 98 OF 2013 EFFECTIVE 160 DAYS AFTER THE EFFECTIVE DATE, AS PUBLISHED IN THE FEDERAL REGISTER, OF AN ORDER BY THE ADMINISTRATOR OF THE UNITED STATES ENVIRONMENTAL PROTECTION AGENCY UNDER 40 CFR 233.53(c)(8)(vi) WITHDRAWING APPROVAL OF THE STATE PROGRAM UNDER 33 USC 1344(g) AND (h). (See enacting section 2 of Act 98 of 2013.) \*\*\*\*\***

**324.30305 Activities not requiring permit under part; uses allowed without permit; farming operation in wetland not requiring permit; incidental creation of wetland; area created as result of commercial excavation; activities not subject to regulation; subsection (6) inapplicable to certain lands; "agricultural drain" defined.**

Sec. 30305. (1) Activities that require a permit under part 325 or part 301 or a discharge that is authorized

by a discharge permit under section 3112 or 3113 do not require a permit under this part.

(2) The following uses are allowed in a wetland without a permit subject to other laws of this state and the owner's regulation:

- (a) Fishing, trapping, or hunting.
- (b) Swimming or boating.
- (c) Hiking.

(d) Grazing of animals, including fencing and post placement if the fence is designed to control livestock, does not exceed 11 feet in height, and utilizes an amount of material that does not exceed that of a woven wire fence utilizing 6-inch vertical spacing and posts.

(e) Farming, horticulture, silviculture, lumbering, and ranching activities, including plowing, irrigation, irrigation ditching, seeding, cultivating, minor drainage, harvesting for the production of food, fiber, and forest products, or upland soil and water conservation practices. All of the following apply for the purposes of this subdivision:

(i) Beginning October 1, 2013, to be allowed in a wetland without a permit, these activities shall be part of an established ongoing farming, ranching, horticultural, or silvicultural operation. Farming and silvicultural activities on areas lying fallow as part of a conventional rotational cycle are part of an established ongoing operation, unless modifications to the hydrological regime or mechanized land clearing are necessary to resume operation. Activities that bring into farming, ranching, horticultural, or silvicultural use an area not in any of these uses, or that convert an area from a forested or silvicultural use to a farming, ranching, or horticultural use, are not part of an established ongoing operation.

(ii) Minor drainage does not include drainage associated with the immediate or gradual conversion of a wetland to a nonwetland, or conversion from 1 wetland use to another. Minor drainage does not include the construction of a canal, ditch, dike, or other waterway or structure that drains or otherwise significantly modifies a stream, lake, or wetland.

(iii) Wetland altered under this subdivision shall not be used for a purpose other than a purpose described in this section without a permit from the department.

(f) Maintenance or operation of serviceable structures in existence on October 1, 1980 or constructed pursuant to this part or former 1979 PA 203.

(g) Construction or maintenance of farm or stock ponds.

(h) Maintenance of an agricultural drain, regardless of outlet, if all of the following requirements are met:

(i) The maintenance includes only activities that maintain the location, depth, and bottom width of the drain as constructed or modified at any time before July 1, 2014.

(ii) The maintenance is performed by the landowner or pursuant to the drain code of 1956, 1956 PA 40, MCL 280.1 to 280.630.

(iii) The maintenance does not include any modification that results in additional wetland drainage or conversion of a wetland to a use to which it was not previously subject.

(i) Maintenance of a drain that was legally established and constructed pursuant to the drain code of 1956, 1956 PA 40, MCL 280.1 to 280.630, if the drain was constructed before January 1, 1973 or under a permit issued pursuant to this part. As used in this subdivision, "maintenance of a drain" means the physical preservation of the location, depth, and bottom width of a drain and appurtenant structures to restore the function and approximate capacity of the drain as constructed or modified at any time before July 1, 2014, including the placement of spoils removed from the drain in locations along that drain where spoils have been previously placed. Maintenance of a drain under this subdivision does not include any modification that results in additional wetland drainage or conversion of a wetland to a use to which it was not previously subject.

(j) Construction or maintenance of farm roads, forest roads, or temporary roads for moving mining or forestry equipment, if the roads are constructed and maintained in a manner to ensure that any adverse effect on the wetland will be minimized. Borrow material for road construction or maintenance shall be taken from upland sources if feasible. In determining whether an alternative will minimize any adverse effect on the wetland, the department shall consider cost, existing technology, and logistics in light of overall project purposes.

(k) Maintenance of public streets, highways, or roads that meets all of the following requirements:

(i) Does not include any modification that changes the original location or footprint.

(ii) Is done in a manner that minimizes any adverse effect on the wetland.

(l) Maintenance or repair of utility lines and associated support structures that meets all of the following requirements:

(i) Is done in a manner that minimizes any adverse effect on the wetland.

(ii) Does not include any modification to the character, scope, or size of the originally constructed design.

(iii) Does not convert a wetland area to a use to which it was not previously subject.

For the purposes of this subdivision and subdivision (m), "utility line" means any pipe or pipeline used for the transportation of any gaseous, liquid, liquescent, or slurry substance, for any purpose, and any cable, line, or wire for the transmission for any purpose of electrical energy, telephone or telegraph messages, or radio or television communication.

(m) Installation of utility lines having a diameter of 6 inches or less using directional drilling or boring, or knifing-in, and the placement of poles with minimal (less than 1 cubic yard) structure support, if the utility lines and poles are installed in a manner that minimizes any adverse effect on the wetland. Directional drilling or boring under this subdivision shall meet all of the following requirements:

(i) The top of the utility line is at least 4 feet below the soil surface of the wetland. However, if the presence of rock prevents the placement of the utility line at the depth otherwise required by this subparagraph, the bottom of the utility line is not placed higher than the top of the rock.

(ii) The entry and exit holes are located a sufficient distance from the wetland to ensure that disturbance of the wetland does not occur.

(iii) The operation does not result in the eruption or release of any drilling fluids up through the ground and into the wetland and there is an adequate plan to respond to any release of drilling mud or other fill material.

(n) Operation or maintenance, including reconstruction of recently damaged parts, of serviceable dikes and levees in existence on October 1, 1980 or constructed pursuant to this part or former 1979 PA 203.

(o) Placement of biological residuals from activities, including the cutting of woody vegetation or the in-place grinding of tree stumps, performed under this section within a wetland, if all the biological residuals originate within that wetland.

(3) An activity in a wetland that was effectively drained for farming before October 1, 1980 and that on and after October 1, 1980 has continued to be effectively drained as part of an ongoing farming operation is not subject to regulation under this part.

(4) A wetland that is incidentally created as a result of 1 or more of the following activities is not subject to regulation under this part:

(a) Excavation as part of commercial sand, gravel, or mineral mining, if the area was not a wetland before excavation. This exemption from regulation applies until the property on which the wetland is located meets both of the following requirements:

(i) Is no longer used for excavation as part of commercial sand, gravel, or mineral mining.

(ii) Is being used for another purpose unrelated to excavation as part of commercial sand, gravel, or mineral mining.

(b) Construction and operation of a water treatment pond, lagoon, or storm water facility in compliance with the requirements of state or federal water pollution control laws.

(c) A diked area associated with a landfill if the landfill complies with the terms of the landfill construction permit and if the diked area was not a wetland before diking.

(d) Construction of drains in upland for the sole purpose of removing excess soil moisture from upland areas that are primarily in agricultural use.

(e) Construction of roadside ditches in upland for the sole purpose of removing excess soil moisture from upland.

(f) An agricultural soil and water conservation practice designed, constructed, and maintained for the purpose of enhancing water quality.

(5) An area that becomes contiguous to a water body created as a result of commercial excavation for sand, gravel, or mineral mining is not subject to regulation under this part solely because it is contiguous to the created water body. This exemption from regulation applies until the property on which the wetland is located meets both of the following requirements:

(a) Is no longer used for excavation as part of commercial sand, gravel, or mineral mining.

(b) Is being used for another purpose unrelated to excavation as part of commercial sand, gravel, or mineral mining.

(6) Except as provided in subsection (7), the following activities are not subject to regulation under this part:

(a) Leveling of sand, removal of vegetation, grooming of soil, or removal of debris, in an area of unconsolidated material predominantly composed of sand, rock, or pebbles, located between the ordinary high-water mark and the water's edge.

(b) Mowing of vegetation between the ordinary high-water mark and the water's edge.

(7) Subsection (6) does not apply to lands included in the survey of the delta of the St. Clair River, otherwise referred to as the St. Clair flats, located within Clay township, St. Clair county, as provided for in 1899 PA 175.

(8) As used in this part, "agricultural drain" means a human-made conveyance of water that meets all of the following requirements:

- (a) Does not have continuous flow.
- (b) Flows primarily as a result of precipitation-induced surface runoff or groundwater drained through subsurface drainage systems.
- (c) Serves agricultural production.
- (d) Was constructed before January 1, 1973, or was constructed in compliance with this part or former 1979 PA 203.

**History:** Add. 1995, Act 59, Imd. Eff. May 24, 1995;—Am. 1996, Act 550, Imd. Eff. Jan. 15, 1997;—Am. 2003, Act 14, Imd. Eff. June 5, 2003;—Am. 2012, Act 247, Imd. Eff. July 2, 2012;—Am. 2013, Act 98, Imd. Eff. July 2, 2013;—Am. 2018, Act 631, Eff. Mar. 29, 2019.

**Popular name:** Act 451

**Popular name:** NREPA

**Popular name:** Wetland Protection Act

\*\*\*\*\* 324.30305b *THIS SECTION IS REPEALED BY ACT 98 OF 2013 EFFECTIVE 160 DAYS AFTER THE EFFECTIVE DATE, AS PUBLISHED IN THE FEDERAL REGISTER, OF AN ORDER BY THE ADMINISTRATOR OF THE UNITED STATES ENVIRONMENTAL PROTECTION AGENCY UNDER 40 CFR 233.53(c)(8)(vi) WITHDRAWING APPROVAL OF THE STATE PROGRAM UNDER 33 USC 1344(g) AND (h). (See enacting section 2 of Act 98 of 2013.)* \*\*\*\*\*

### **324.30305b Cranberry beds.**

Sec. 30305b. (1) The department shall consider construction of cranberry beds, including associated dikes and water control structures associated with dikes, such as headgates, weirs, and drop inlet structures, to be a water dependent activity.

(2) The following activities associated with cranberry operations are not considered to be water dependent:

(a) The construction of roads, ditches, reservoirs, and pump houses that are used during the cultivation of cranberries.

(b) The construction of secondary support facilities for shipping, storage, packaging, parking, and similar purposes.

(3) The demonstration by an applicant under section 30311 that there is no feasible and prudent alternative to the construction of cranberry beds, including dikes and water control structures associated with dikes, is not subject to either of the following presumptions:

(a) That feasible and prudent alternatives that do not involve a wetland are available.

(b) That a feasible and prudent alternative that does not affect a wetland will have less adverse effects on the aquatic ecosystem.

**History:** Add. 2009, Act 120, Eff. Nov. 6, 2009.

**Compiler's note:** Enacting section 1 of Act 120 of 2009 provides:

"Enacting section 1. This amendatory act does not take effect unless both of the following requirements are met:

"(a) \$4,000,000.00 from the cleanup and redevelopment trust fund created in section 3e of 1976 IL 1, MCL 445.573e, and \$4,000,000.00 from the community pollution prevention fund created in section 3f of 1976 IL 1, MCL 445.573f, is appropriated by the legislature to the environmental protection fund created in section 503a of the natural resources and environmental protection act, 1994 PA 451, MCL 324.503a.

"(b) \$2,000,000.00 is appropriated by the legislature from the environmental protection fund to support the program under part 303 of the natural resources and environmental protection act, 1994 PA 451, MCL 324.30301 to 324.30329."

**Popular name:** Act 451

**Popular name:** NREPA

**Popular name:** Wetland Protection Act

\*\*\*\*\* 324.30306 *THIS SECTION IS REPEALED BY ACT 98 OF 2013 EFFECTIVE 160 DAYS AFTER THE EFFECTIVE DATE, AS PUBLISHED IN THE FEDERAL REGISTER, OF AN ORDER BY THE ADMINISTRATOR OF THE UNITED STATES ENVIRONMENTAL PROTECTION AGENCY UNDER 40 CFR 233.53(c)(8)(vi) WITHDRAWING APPROVAL OF THE STATE PROGRAM UNDER 33 USC 1344(g) AND (h). (See enacting section 2 of Act 98 of 2013.)* \*\*\*\*\*

### **324.30306 Permit for use or development listed in MCL 324.30304; filing, form, and contents of application; proposed use or development as single permit application; fee; work done in violation of permit requirement; fee refund; conditional permit.**

Sec. 30306. (1) Except as provided in section 30307(6), to obtain a permit for a use or development listed



# Economic Benefits of Wetlands

*A wetland is a natural area that is often wet but may not be wet all year round.*

*Wetlands are characterized by their distinctive hydrology, soils and plants. Once regarded as wastelands, wetlands are now recognized as important features of the landscape that provide numerous beneficial services for people and wildlife. The economic value of a wetland is an estimate of the importance, or worth, of one or more of its services to society. Some of these services, or functions, include protecting and improving water quality, supporting the fishing industry, storing floodwaters and providing opportunities for education and recreation. If wetlands are destroyed or damaged, it can be difficult or impossible to replace all of these functions.*

*Wetlands contribute to the national and local economies by producing resources, enabling recreational activities and providing other benefits, such as pollution control and flood protection. While it can be difficult to calculate the economic value provided by a single wetland, it is possible to evaluate the range of services provided by all wetlands and assign a dollar value. These amounts can be impressive. According to one assessment of natural ecosystems, the dollar value of wetlands worldwide was estimated to be \$14.9 trillion. (Source: Costanza et al. 1997) This fact sheet summarizes some of the important ways in which wetlands contribute to the economy.*



## Drinking Water Quality



Wetlands improve water quality in rivers and streams. They are valuable filters for water that may eventually become drinking water.

Wetlands improve water quality in nearby rivers and streams, and thus have considerable value as filters for future drinking water. When water enters a wetland, it slows down and moves around wetland plants. Much of the suspended sediment drops out and settles to the wetland floor. Plant roots and microorganisms on plant stems and in the soil absorb excess nutrients in the water from fertilizers,

manure, leaking septic tanks and municipal sewage. While a certain level of nutrients is necessary in water ecosystems, excess nutrients can cause algae growth that's harmful to fish and other aquatic life. A wetland's natural filtration process can remove excess nutrients before water leaves a wetland, making it healthier for drinking, swimming and supporting plants and animals. For example, the Congaree Bottomland Hardwood Swamp in South Carolina removes a quantity of pollutants from the watershed equivalent to that which would be removed by a \$5 million treatment plant. (Source: EPA832-R-93-005)

## Flood Control

Flood damages in the U.S. average \$2 billion each year, causing significant loss of life and property. (Source: National Oceanic and Atmospheric

Administration). Wetlands can play a role in reducing the frequency and intensity of floods by acting as natural buffers, soaking up and storing a significant amount of floodwater. A wetland can typically store about three-acre feet of water, or one million gallons. An acre-foot is one acre of land, about three-quarters the size of a football field, covered one foot deep in water. Three acre-feet describes the same area of land covered by three feet of water. Coastal wetlands serve as storm surge protectors when hurricanes or tropical storms come ashore. In the Gulf coast area, barrier islands, shoals, marshes, forested wetlands and other features of the coastal landscape can provide a significant and potentially sustainable buffer from wind wave action and storm surge generated by tropical storms and hurricanes. (Source: Working Group for Post-Hurricane Planning for the Louisiana Coast) After peak flood flows have passed, wetlands slowly release the stored waters, reducing property damage downstream or inland. One reason floods have become more costly is that over half of the wetlands in the United States have been drained or filled. The loss of more than 64 million acres of wetlands in the Upper Mississippi Basin since the 1780's contributed to high floodwaters during the Great Flood of 1993 that caused billions of dollars in damage. (Source:

"Flood Damage Reduction in the Upper Mississippi River Basin—An Ecological

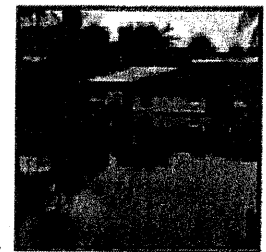

One of the most valuable benefits of wetlands is their ability to store flood waters. Maintaining only 15% of the land area of a watershed in wetlands can reduce flooding peaks by as much as 60%. (Source: The Wetlands Initiative, EPA) [See EPA843-F-06-001, "Wetlands and Flooding."]





## Valuation of Wetlands

Although wetlands provide important services to society, these services are typically not sold nor do they have market value. Wetland benefits can be estimated by several standard market and non-market valuation techniques. The three most common are cost-benefit analysis, cost-effectiveness analysis and benefits valuation for compensation for environmental damages. The techniques can be applied whether the change in the environment is an improvement or degradation. (Source: "Economic Valuation of Environmental Benefits")

Alternative", 2004) The damage sustained by the Gulf Coast during Hurricane Katrina could have been less severe if more wetlands along the coast and Mississippi delta had been in place.

## Cleaning the Water

Because natural wetlands are so effective at removing pollutants from water that flows through them, engineers and scientists construct systems that replicate some of the functions of natural wetlands.



Annette Davis

Natural wetlands are effective at cleaning the water passing through them. Wetland plants and soils absorb much of the excess nutrients in the water. Wetlands perform this function so well that similar systems are being constructed to treat wastewater.

These constructed treatment wetlands use natural processes involving wetland vegetation, soils and their associated microbial life to improve water quality. They are often less expensive to build than traditional wastewater and stormwater treatment options, have low operating and maintenance expenses and can handle fluctuating water levels. For example, in 1990 city managers in

Phoenix, Arizona, needed to improve the performance of a wastewater treatment plant to meet new state water quality standards. After learning that upgrading the plant might cost as much as \$635 million, the managers started to look for a more cost-effective way to provide final treatment to the plant's wastewater discharge into the Salt River. A preliminary study suggested that a constructed wetland system would sufficiently clean the discharge water while supporting high-quality wetland habitat for birds, including endangered species, and protecting downstream residents from flooding. All these benefits would be achieved at a lower cost than retrofitting the existing treatment plant. As a result, the 12-acre Tres Rios Demonstration Project began in 1993 with assistance from the Corps of Engineers, the Bureau of Reclamation and EPA's Environmental Technology Initiative and now receives about two million gallons of wastewater per day. This project is still flourishing, serving as a home for thousands of birds and other wildlife. (Source: City of Phoenix) There are hundreds of wastewater treatment wetlands operating in the United States today. (Source: EPA832-R-93-005)

## Fisheries

The Nation's wetlands are vital to fish health and

thus to the Nation's multi-billion dollar fishing industry. Wetlands provide an essential link in the life cycle of 75 percent of the fish and shellfish commercially harvested in the U.S., and up to 90 percent of the recreational fish catch. Wetlands provide a consistent food supply, shelter and nursery grounds for both marine and freshwater species. Landings of crab, shrimp and salmon were valued at

\$1,167 billion in 2004. These species are dependent on wetlands for at least part of their life cycles. In 2004 the dockside value of fin fish and shellfish landed in the United States was \$3.7 billion and was the basis for the \$7.2 billion fishery processing business. U.S. consumers spent an estimated \$54.4 billion for fishery products in 2000. (Source: U. S. Fish and Wildlife Service (USFWS), National Oceanic and Atmospheric Administration (NOAA), National Marine Fisheries Service (NMFS))



Wetlands are essential to our multi-billion dollar National commercial fishing industry. Wetlands have an important place in the life cycle of 75 percent of the fish and shellfish commercially landed in U.S. waters.

## Recreation

Wetlands are often inviting places for popular recreational activities including hiking, fishing, bird watching, photography and hunting. More than 82 million Americans took part in these activities in 2001, spending more than \$108 billion on these pursuits. (Source: USFWS, Ducks Unlimited). For example, over 34 million people went fishing in 2001, spending an average of \$1,046 and 16 days



Wetlands are pleasant places for recreational activities like fishing. They may provide a place of natural beauty and solitude that can be enjoyed by persons of all ages who may seldom be exposed to nature.

each on the water. Anglers spent \$14.7 billion in 2001 for fishing trips, \$17 billion on equipment and \$4 billion for licenses, stamps, tags, land leasing and ownership, membership dues, contributions and magazines. The overall economic impact of recreational fishing is estimated at \$116 billion (American Sportfishing Association), and wetlands play a crucial role in the life cycle of up to 90 percent of the fish caught recreationally. In 2001, approximately 3 million people hunted migratory birds, and 6.5 million small mammals that are often

percent of the fish caught recreationally. In 2001, approximately 3 million people hunted migratory birds, and 6.5 million small mammals that are often

found in wetlands. They spent more than \$2.2 billion, including \$111 million paid by migratory bird and large game hunters to lease hunting areas and blinds, often located on private property with wetlands. (Source: U. S. Fish and Wildlife Service) Each year nearly \$200 million in hunters' federal excise taxes are distributed to state agencies to support wildlife management programs, the purchase of lands open to hunters and hunter education and safety classes. Proceeds from the federal Duck Stamp, a required purchase of migratory water fowl hunters, have purchased more than five million acres of habitat for the refuge system. (Source: Ducks Unlimited) Just watching the wildlife, many of which depend on wetlands, has become a popular pastime. More than 66 million people 16 years old and older--31% of all Americans-- fed, photographed and observed wildlife in 2001 and spent \$40 billion on their activities. (Source: U. S. Fish and Wildlife Service)

## Wildlife Habitat



Patricia Deese

Many species of wildlife rely on wetlands for their very existence. Wetlands provide mammals, plants, amphibians, reptiles, birds and fish with food, habitat, breeding grounds and shelter. While the diversity of wetland wildlife contributes to many businesses, they are also inherently wonderful to observe.

Diverse species of mammals, plants, insects, amphibians, reptiles, birds and fish rely on wetlands for food, habitat or shelter. Wetlands are some of the most biologically productive natural ecosystems in the world, comparable to tropical rain forests or coral reefs in the number and variety of species they support. Although wetlands make up only about 5 percent of the land area of the lower 48 states, more than one-third of threatened and endangered species live only in wetlands. An additional 20% of the country's threatened and endangered species use or inhabit wetlands at some time in their life.

Some species must have a wetland in order to reproduce. Migrating waterfowl rely on wetlands for resting, eating and breeding areas, leading to increased populations. As noted, the appeal of wetlands and the diversity of plant and animal life they attract contribute to or support many businesses. (Source: U.S. Fish and Wildlife Service)

## Other Commercial Benefits

Many industries, in addition to the fishing industry, derive benefits or produce products dependent on wetlands. Part of this economic value lies in the variety of commercial products they provide, such as food and energy sources. Rice can be grown in a wetland during part of the year, and the same area can serve as a wildlife habitat for the rest of the year. Some wetland plant species, such as wild rice and various reeds, can be harvested for or used to produce specialty foods, medicines, cosmetics and decorative items. In many coastal and river delta wetlands, haying of wetland vegetation is important to livestock producers. In Europe, reed-growing for building materials is undergoing a

revival in some countries as people realize the full potential of reeds as a roofing material. Aesthetically pleasing, thatched roofs are superior insulators to conventional tile roofs, and they have a life span of 25-40 years. (Source: Ramsar) Fur-bearing animals, such as mink, muskrat and beaver, use wetlands during some part of their life cycle. Income can be derived from trapping these furbearers, either by direct sale of their pelts or by leasing wetlands for the fur harvest. The nation's harvest of muskrat pelts alone was worth \$124 million in 2004. (Source: U.S. Fish and Wildlife Service) Wetlands also provide employment opportunities, including such positions as surveyor or park ranger. The production of raw materials from wetlands provides jobs to those employed in the commercial fishing, specialty food and cosmetic industries. These are billion dollar industries that depend in part on wetlands to flourish.

In addition to the many ways wetlands provide economic benefits, they offer numerous less tangible benefits as well. These include providing aesthetic value to residential communities, reducing streambank erosion and providing educational opportunities as an ideal "outdoor classroom." By nearly any measure used, it pays to save wetlands.



## Did You Know?

- Although wetlands cover only about 5 percent of the land surface in the lower 48 states, they are home to 31 percent of plant species. (U.S. Fish and Wildlife Service)
- In 2002 Louisiana commercial fish landings exceeded 1 billion pounds with a dockside value of \$343 million – approximately 30% of the total catch by weight in the lower 49 states. (Source: America's Wetland)
- Rivaling the likes of tropical rainforests and coral reefs, wetlands are among the most fertile, productive ecosystems in the world. (Source: Ramsar)
- Two thirds of all fish consumed worldwide are dependent on coastal wetlands at some stage in their life cycle. (Source: Ramsar)
- Annual fish and seafood production in swamps and marshes worldwide has been estimated at an average of nine tons per square kilometer, 259 hectares or 640 acres. (Source: Ramsar)
- As many as one-half of all North American bird species nest or feed in wetlands.
- Five to seven million migratory waterfowl, including the endangered whooping crane, use wetlands, i.e. prairie potholes, as resting and feeding areas and as an abundant food source. (Source: U.S. Fish and Wildlife Service)

# References

## On the Internet:

- American Sportfishing Association . . . . . [www.asafishing.org](http://www.asafishing.org)
- "A New Framework for Planning the Future of Coastal Louisiana after the Hurricanes of 2005." Working Group for Post-Hurricane Planning for the Louisiana Coast. University of Maryland Center for Environmental Science . . . . . [www.umces.edu/la-restore](http://www.umces.edu/la-restore)
- "Constructed Wetlands for Wastewater Treatment and Wildlife Habitat: 17 Case Studies." (EPA832-R-93-005) 1993. U.S. Environmental Protection Agency, Washington, DC . . . . . [www.epa.gov/owow/wetlands](http://www.epa.gov/owow/wetlands)
- Ducks Unlimited . . . . . [www.ducks.org](http://www.ducks.org)
- "Economic Valuation of Environmental Benefits" . . . . . [www.nemw.org/ERconval.htm](http://www.nemw.org/ERconval.htm)
- "Economic Valuation of Wetlands: A Guide for Policy Makers and Planners" . . . . . [www.ramsar.org](http://www.ramsar.org)
- "Flood Damage Reduction in the Upper Mississippi River Basin – An Ecological Alternative." 2004. Donald L. Hey, et al. The Wetlands Initiative, Chicago, IL . . . . . [www.wetlands-initiative.org](http://www.wetlands-initiative.org)
- "National List of Plant Species that Occur in Wetlands: 1988 National Summary." Porter B. Reed for U.S. Fish and Wildlife Service in cooperation with the U.S. Army Corps of Engineers, U.S. Environmental Protection Agency, U.S. Soil Conservation Service . . . . . [www.nwi.fws.gov/bha](http://www.nwi.fws.gov/bha)
- National Marine Fisheries Service . . . . . [www.nmfs.noaa.gov](http://www.nmfs.noaa.gov)
- National Oceanic and Atmospheric Administration . . . . . [www.noaa.gov/floods.html](http://www.noaa.gov/floods.html)
- "National Survey of Fishing, Hunting and Wildlife-Associated Recreation" . . . . . [www.fws.gov](http://www.fws.gov)
- "Status and Trends of Wetlands in the Conterminous United States 1998 to 2004." . . . . . [http://wetlandsfws.er.usgs.gov/status\\_trends/index.html](http://wetlandsfws.er.usgs.gov/status_trends/index.html)

## In Print:

Constanza, R. R., R. d'Arge, R. de Groot, S. Farber, M. Grasso, B. Hannon, K. Limburg, S. Naeem, R.V. O'Neill, J. Paruelo, R.G. Raskin, P. Sutton, and M. van der Belt. 1997. "The value of the world's ecosystem services and natural capital." *Nature* 387:253-260

For additional information, visit the U.S. EPA's website ([www.epa.gov/owow/wetlands](http://www.epa.gov/owow/wetlands)), or call the toll-free Wetlands Helpline at 1-800-832-7828.

## Connie Preston

---

**From:** Jeff Shaw  
**Sent:** Tuesday, February 15, 2022 10:32 AM  
**To:** Connie Preston  
**Subject:** Fw: Greilickville Harbor Park Seawall Repair Update  
**Attachments:** 20220210131846990.pdf

For next meeting.

---

**From:** Schwerdt, Kenneth <kschwerdt@wadetrim.com>  
**Sent:** Monday, February 14, 2022 10:00 AM  
**To:** Jeff Shaw <supervisor@elmwoodmi.gov>  
**Cc:** Sousa, Brian C. <BSOUSA@WadeTrim.com>  
**Subject:** Greilickville Harbor Park Seawall Repair Update

Hi Jeff,

I met with Molon Excavating out at Greilickville Harbor Park the end of last week to review the seawall repair. They have submitted the attached quote for patching the face of the wall with rock and backfilling the washed out area behind the wall where the sinkhole was forming. This quote is for time and materials with an estimate of time and area to be fixed. There is a rate sheet included with the quote. The attached \$10,200 estimate for the repair assumes 25' of wall and backfill repair area behind the wall. Molon would be able to do this repair in the very near future, and even included cost for snow removal to access the site.

The site conditions have changed since last fall with the water being a foot lower now. We were able to get down in front of the wall and could see further into the void that has hollowed out behind the existing seawall. It appears that the void is larger than we thought last fall, and extends laterally behind the wall for a distance estimated to be 10 feet or more in addition to the 10' wide area that is open at the wall.

The previous quote from Elmers last fall for \$8,366 was based on just the 10' wide area of repair open at the wall that we could assess at that time. Since the Elmers quote had an acceptance deadline that has expired, they would have an opportunity to revise their costs as needed. I have contacted Steve Folkersma with Elmers and they are updating their quote today. I will let you know when I hear back from them.

Let me know if you have any questions.

Thanks,



Ken Schwerdt, Professional Engineer  
10850 E. Traverse Highway, Suite 2260, Traverse City, MI 49684  
231.878.4827 cell





Est. 1978

February 10, 2022

**PROPOSAL SUBMITTED TO:**

**Mr. Ken Schwerdt PE**  
**10850 E Traverse Hwy**  
**Suite 2260**  
**Traverse City, MI**

**WE HEREBY SUBMIT SPECIFICATIONS AND ESTIMATES FOR:**

**Re: Elmwood Township Park Seawall Repair**  
**1 Area approximately 25' in length**

**WORK ITEMS AND SPECIFICATIONS INCLUDE THE FOLLOWING**

- A) Mobilization of required equipment
- B) Snow plow road & sidewalk as needed
- C) Furnish & place filter fabric & 12" to 16" rip-rap as required to repair seawall face
- D) Fill void between seawall face & sidewalk with 6A crushed stone
- E) Install filter fabric & topsoil over 6A to match existing grade
- F) Dune grass planting & final restoration by others

**Estimated total cost: \$10,200.00**

- 1) Project to be performed on a T&M basis per attached rate sheet
- 2) Estimated project duration 2 days

If you have any questions feel free to call me at (231)-943-3929 or (231)-218-9357.  
*This proposal may be withdrawn by us if not accepted within -60- days.*

Signature  \_\_\_\_\_  
MOLON EXCAVATING, INC. (Mike Walton)

February 10, 2022  
Date

**Acceptance of Contract** – The above prices, specifications, and conditions are satisfactory and  
Are hereby accepted. You are authorized to do the work as specified.

Signature \_\_\_\_\_  
(Authorized Signature)

\_\_\_\_\_  
Date

125 Buckshot Drive • Traverse City, Michigan 49685 • P: 231-943-3929 • F: 231-943-3954 • www.molonexcavating.net

**SITWORK • SEWER & WATER • MARINE • SHORELINE RESTORATION**

## Operated Equipment Rates 2022

Category #	Description	HR	Day	Snow	W/GPS
<b>10</b>	<b>Labor</b>				
11	Labor	\$ 90.00			\$ 120.00
<b>100</b>	<b>Small Trucks</b>				
110	Pickup Truck Unoperated	\$ 55.00			
120	Pickup Truck	\$ 105.00			
130	One Ton Truck	\$ 110.00			
<b>200</b>	<b>Large Trucks</b>				
210	Tandem Axle Dump Truck	\$ 130.00			
220	Water Truck(Mack)	\$ 190.00			
230	Vac Truck	\$ 295.00			
240	Semi Truck	\$ 125.00			
250	Semi/Lead Trailer	\$ 145.00			
260	Semi/Train	\$ 165.00			
270	Lowboy Trailer	\$ 175.00			
280	Misc. Job Trailer		\$ 20.00		
<b>300</b>	<b>Compaction Equipment</b>				
310	84" Roller	\$ 135.00			
<b>400</b>	<b>Crushing Equipment</b>				
410	Pulverizer	\$ 680.00			
<b>800</b>	<b>Loaders</b>				
810	Loader 938/950	\$ 165.00			
820	Skid-Steer	\$ 125.00			\$ 150.00
<b>900</b>	<b>Dozers</b>				
910	450/550/650/D3 Dozer	\$ 155.00			\$ 175.00
920	D6K2 Dozer	\$ 165.00			\$ 185.00
<b>1000</b>	<b>Graders</b>				
1010	JD 872	\$ 190.00			\$ 200.00
1020	Champion	\$ 170.00			
1030	JD 570	\$ 150.00			
<b>1100</b>	<b>Excavators</b>				
1110	Excavator Mini	\$ 125.00			
1120	Bobcat w/piertech	\$ 140.00			
1130	JD 120	\$ 140.00			
1140	Cat 315	\$ 145.00			
1150	Cat 323/Doosan/JD 210	\$ 160.00			\$ 175.00
1160	JD 300	\$ 180.00			
1170	JD 350	\$ 190.00			
1180	Hitachi 450	\$ 220.00			
1190	Long Reach	\$ 240.00			
<b>1200</b>	<b>Mass Earth Equipment</b>				
1210	Earthmover Single	\$ 225.00			
1220	Earthmover Double	\$ 260.00			
1230	Earthmover 613 Paddle	\$ 195.00			
1240	Off Road Water Truck	\$ 190.00			

1250	Off Road Haul Truck	\$ 200.00			
<b>1300</b>	<b>Cranes</b>				
1310	Grove	\$ 200.00			
1320	Link Belt	\$ 300.00			
<b>1400</b>	<b>Screening Equipment</b>				
1410	Screen Plant Topsoil	\$ 275.00			
<b>1500</b>	<b>Small Equipment</b>				
1510	Walk Behind Compactor		\$ 175.00		
1520	Chain Saw		\$ 150.00		
1530	Quickie Saw		\$ 150.00		
1540	Floor Saw		\$ 125.00		
1550	Pumps		\$ 100.00		
1560	Laser		\$ 100.00		
1570	Welders		\$ 100.00		
1580	Ditchwitch Trencher		\$ 110.00		
1590	Toro Dingo		\$ 110.00		
<b>1600</b>	<b>Misc Equipment</b>				
1601	Sweeper	\$ 115.00			
1610	H&M H-150 Hammer	\$ 150.00			
1620	Delmag Diesel Hammer	\$ 175.00			
1630	Survey Boat		\$ 250.00		
1640	25' Inland Seas Boat		\$ 350.00		
1650	Work Barge		\$ 250.00		
1660	Trench Boxes(any)		\$ 150.00		
1670	Stone Boat		\$ 150.00		
1680	Sullair 185 Compressor		\$ 150.00		
1690	Onan Generator		\$ 225.00		
<b>1700</b>	<b>Seeding Equipment</b>				
1710	Bale Mulcher		\$ 175.00		
1720	Brillion Seeder w/tractor		\$ 150.00		
1730	Hydro Seeder		\$ 500.00		
1740	Arctic Cat ATV	\$ 100.00			





**PROPOSAL**

P.O. Box 6150 Traverse City, MI 49696-6150  
1.800.3ELMERS • 231.943.3443 • 231.943.8975 Fax  
www.TeamElmers.com  
EOE/AA

Proposal submitted to: **Wade Trim**  
**Attn: Ken Schwerdt**  
**10850 E Traverse Hwy #2260**  
**Traverse City, MI 49684**

**2/14/2022**

**Proposal 2021-5635**

We hereby submit specifications and estimates for:

**Re: Elmwood Township Park**

**Provide labor, equipment and materials to perform the following work on Elmwood Township Park retaining wall:**

- 1 Mobilize equipment
- 2 Remove broken concrete pieces in water
- 3 Import and place 6AA crushed stone in void from front side of wall
- 4 Dig up void between sidewalk and wall, place 6AA crushed stone in void
- 5 Place fabric over stone
- 6 Import and place topsoil on disturbed area
- 7 Import and place 16"-24" quarry stone and place in water in front of void

**Total: \$15,732.00**

Price does not include seeding or dune grass replacement (to be done by others)

*Depending on the Fall of 2021 weather, this work may need to be completed in the 2022 construction season.*

The foregoing proposal is explicitly conditioned upon the fact that Team Elmer's and its employees, officers, directors affiliates, subsidiaries, or successors, is NOT subject to and DOES NOT assume any obligations relating to wages, hours, benefits or any other terms and conditions of any labor agreement the recipient of this proposal or any other contractor or entity associated with the quoted work may be party. RATHER, ANY SUCH OBLIGATIONS ARE SPECIFICALLY DISCLAIMED.

**I can be reached directly at 231-218-6018 or sf206@teamelmers.com**

**Thank you for the opportunity to bid this project**

All material is guaranteed to be as specified. All work to be completed in a workmanlike manner according to standard practices. Any alteration or deviation from above specifications involving extra costs will be executed only upon written orders, and will become an extra charge over and above the estimate. All agreements contingent upon strikes, accidents or delays beyond our control. Owner to carry fire, tornado and other necessary insurance. Our workers are fully covered by Workers' Compensation Insurance. The General Conditions attached hereto or appearing on the back side of this Proposal are hereby incorporated by reference.

TEAM Elmers Authorized Signature

Name: **Steve Folkersma**

Note: This proposal may be withdrawn by us if not accepted within **30** days.

**Acceptance of Proposal**

The above prices, specifications and conditions are satisfactory and are hereby accepted. You are authorized to do the work as specified.

Signature \_\_\_\_\_ Date of Acceptance \_\_\_\_\_  
(Sign and return copy upon acceptance)

A finance charge of 1.5% per month, which is an annual percentage rate of 18% per year, or a minimum charge of \$.50 per month, shall be applied to all accounts over 30 days past due.

**When reviewing estimates and selecting a contractor:**

- Always get multiple bids for a project. The lowest bid is not necessarily the best choice. Try to get an understanding of why one bid is significantly lower or higher than others; the reasons might change your decision.
- Get recent references from the contractors you are considering.
- Make sure the contractor has the appropriate business and builder licenses, as well as insurance.
- All project specifications and payment terms should be written in the contract.
- The best contractors provide a written warranty or guarantee.

**Fully Bonded & Insured • Daily quality control checks for all products**





600 E Front Street, Suite 104, PO Box 506  
Traverse City MI 49685-0506  
(231) 929-5000 • 1-800-692-7774 • FAX (231) 929-5012  
traversetransportation.org



---

*The mission of the Traverse Transportation Coordinating Initiative (TTCI) is to provide coordinated leadership and direction for the development and conduct of the continuing, cooperative & comprehensive transportation planning process for the Traverse City urban area.*

---

**DATE: February 15, 2022**

**TO: Elmwood Township**

**DESCRIPTION: 2022 TTCI dues**

**AMOUNT: \$1,000**

---

**PLEASE SEND YOUR PAYMENT (make check payable to NW MI COG)**

**Attn: Mary Watson Clark  
Networks Northwest  
PO Box 506  
Traverse City, MI 49685-0506**

If you have any questions concerning this invoice, please contact Jan Warren by phone at 231-633-5819 or by email [jan.warren@networksnorthwest.org](mailto:jan.warren@networksnorthwest.org)

## Connie Preston

---

**From:** Jeff Shaw  
**Sent:** Tuesday, February 22, 2022 4:07 PM  
**To:** Connie Preston  
**Subject:** Fw: Drinking fountains

---

**From:** Will Huddleston <whuddleston@nealisengineering.com>  
**Sent:** Tuesday, February 22, 2022 2:25 PM  
**To:** Jeff Shaw <supervisor@elmwoodmi.gov>  
**Subject:** Drinking fountains

Jeff,

I have been talking to my rep about outdoor drinking fountains. Below are the cost comparisons between refrigerated and non-refrigerated options. He did say that they suggest taking these off the wall and storing indoors during the winter, regardless of if they are filtered or not. If you would like to discuss, please give me a call at the office.

Add to Compare



**VRCTL8WSK**

Elkay ezH2O Vandal-Resistant Bottle Filling Station, & Bi-Level Cooler, Non-Filtered Refrigerated Stainless

**\$4,386.00** (List Price)

[Download spec sheet](#)

Add to Compare



**VRCTLR8WSK**

Elkay ezH2O Vandal-Resistant Bottle Filling Station, & Bi-Level Reverse Cooler, Non-Filtered Refrigerated Stainless

**\$4,386.00** (List Price)

[Download spec sheet](#)

Add to Compare



**VRCTLDDWSK**

Elkay ezH2O Vandal-Resistant Bottle Filling Station, & Bi-Level Cooler, Non-Filtered Non-Refrigerated Stainless

**\$3,855.00** (List Price)

[Download spec sheet](#)

Add to Compare



**VRCTLRDDWSK**

Elkay ezH2O Vandal-Resistant Bottle Filling Station, & Bi-Level Reverse Cooler, Non-Filtered Non-Refrigerated Stainless

**\$3,855.00** (List Price)

[Download spec sheet](#)

Add to Compare



**VRC8WSK**

Elkay ezH2O Vandal-Resistant Bottle Filling Station & Single Cooler, Non-Filtered Refrigerated Stainless

**\$3,297.00** (List Price)

[Download spec sheet](#)

Add to Compare



**VRCDSK**

Elkay ezH2O Vandal-Resistant Bottle Filling Station & Single Cooler, Non-Filtered Non-Refrigerated Stainless

**\$2,995.00** (List Price)

[Download spec sheet](#)

**INVOICE APPROVAL LIST REPORT - SUMMARY BY VENDOR**

PRELIMINARY

Date: 03/08/2022

Time: 3:17 pm

Page: 1

ELMWOOD TOWNSHIP

Vendor Name	Vendor No.	Invoice Description	Check No.	Check Date	Check Amount
ACCIDENT FUND OF MICHIGAN	A050	POLICY WCV0159551 33 03 900931	0	00/00/0000	<b>2,529.00</b>
				Vendor Total:	<b>2,529.00</b>
CITY OF TRAVERSE CITY UTILITIE	C093	ACCT#531765-118432	0	00/00/0000	<b>26.01</b>
				Vendor Total:	<b>26.01</b>
CONSUMERS ENERGY	C040	ACCT#1030 3518 7543	0	00/00/0000	<b>453.58</b>
				Vendor Total:	<b>453.58</b>
EARTHWORKS EXCAVATION, LLC	E006	E TIMBERWOODS PLOWING	0	00/00/0000	<b>1,670.00</b>
				Vendor Total:	<b>1,670.00</b>
GFL ENVIRONMENTAL	M008	ACCT#002114837	0	00/00/0000	<b>113.87</b>
				Vendor Total:	<b>113.87</b>
GRAND TRAVERSE COUNTY DPW	G040	ACCT#4003411	0	00/00/0000	<b>657.16</b>
				Vendor Total:	<b>657.16</b>
GRAND TRAVERSE COUNTY	G200	ELMWOOD GREILICKVILLE WATER	0	00/00/0000	<b>13,506.24</b>
				Vendor Total:	<b>13,506.24</b>
LEELANAU ENTERPRISE & TRIBUN	L020	ADVERTISER #676	0	00/00/0000	<b>126.18</b>
				Vendor Total:	<b>126.18</b>
MAPLE RIVER DIRECT MAIL	M044	PROCESS TAX ASSESSMENTS	0	00/00/0000	<b>1,824.92</b>
				Vendor Total:	<b>1,824.92</b>
NETLINK	M185	TECH SUPPORT	0	00/00/0000	<b>180.00</b>
				Vendor Total:	<b>180.00</b>
RESERVE ACCOUNT	P031	POSTAGE REFILL	0	00/00/0000	<b>3,000.00</b>
				Vendor Total:	<b>3,000.00</b>
STAPLES CREDIT PLAN	S008	ACCT ENDING 5610	0	00/00/0000	<b>210.83</b>
				Vendor Total:	<b>210.83</b>
TEAM BOB'S	B044	FURNACE INSTALL	0	00/00/0000	<b>3,411.77</b>
				Vendor Total:	<b>3,411.77</b>
US BANK OPERATIONS SERVICE (	U030	ACCT#802237600	0	00/00/0000	<b>46,462.50</b>
				Vendor Total:	<b>46,462.50</b>
VERIZON WIRELESS	V014	ACCT#682962913-00001	0	00/00/0000	<b>60.46</b>
				Vendor Total:	<b>60.46</b>
WADE TRIM	W107	SAW GRANT	0	00/00/0000	<b>4,525.58</b>
				Vendor Total:	<b>4,525.58</b>
WELLS FARGO FINANCIAL LEASIN	W027	CONTRACT603-0180923-000	0	00/00/0000	<b>95.40</b>
				Vendor Total:	<b>95.40</b>
YOUNG, GRAHAM, & WENDLING P	Y002	MISC LEGAL	0	00/00/0000	<b>2,532.00</b>
				Vendor Total:	<b>2,532.00</b>
				Grand Total:	<b>81,385.50</b>
				Less Credit Memos:	<b>0.00</b>
				Net Total:	<b>81,385.50</b>
				Less Hand Check Total:	<b>0.00</b>
				Outstanding Invoice Total :	<b>81,385.50</b>

Total Invoices: 22